

23. Wheel Bearing

A: INSPECTION

1. FRONT WHEEL BEARING

NOTE:

Inspect the condition of front wheel bearing grease.

- 1) Lift-up the vehicle.
- 2) While holding the front wheel by hand, swing it in and out to check that there is no bearing free play.
- 3) Loosen the wheel nuts, and remove the front wheel.
- 4) If the bearing free play exists in step 2) above, attach a dial gauge to hub and measure the looseness in the axial direction.

Service limit:

0.05 mm (0.0020 in) Max.

- 5) Remove the bolts and self-locking nuts, and extract transverse link from the front crossmember.
 - 6) Remove the AARi of front drive shaft from transmission. <Ref. to DS-16, Front Axle.>
 - 7) While supporting the front drive shaft horizontally with one hand, turn the hub with the other hand to check for noise or binding.
- If the hub is noisy or binds, disassemble the front axle and replace the oil seals or bearing.

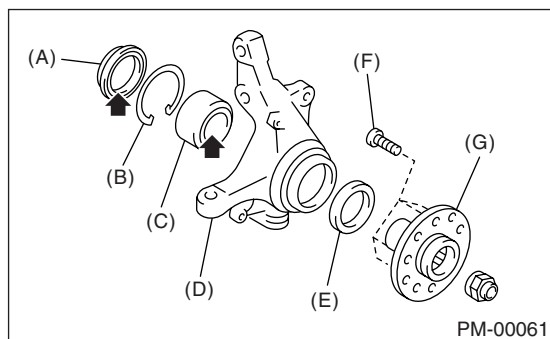

- (A) Inner oil seal
- (B) Snap ring
- (C) Bearing
- (D) Housing
- (E) Outer oil seal
- (F) Hub bolt
- (G) Hub

2. REAR WHEEL BEARING

- 1) Lift-up the vehicle.
- 2) While holding the rear wheel by hand, swing it in and out to check that there is no bearing free play.
- 3) Loosen the wheel nuts, and remove the rear wheel.
- 4) If the bearing free play exists in step 2) above, attach a dial gauge to hub COMPL and measure the looseness in the axial direction.

Service limit:

0.05 mm (0.0020 in) Max.

- 5) Remove the DOJ of rear drive shaft from rear differential. <Ref. to DS-35, Rear Drive Shaft.>
 - 6) While supporting rear drive shaft horizontally with one hand, turn the hub COMPL with the other to check for noise or binding.
- If the hub COMPL is noisy or binds, disassemble the rear axle and replace the oil seals or bearing.

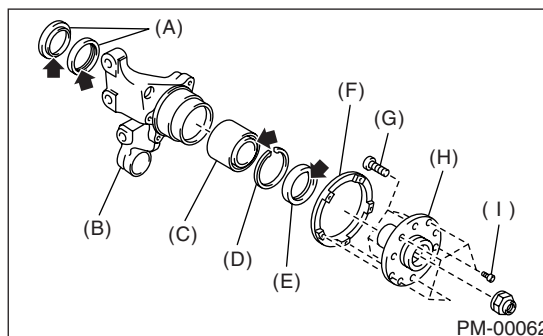

- (A) Inner oil seal
- (B) Rear housing
- (C) Bearing
- (D) Snap ring
- (E) Outer oil seal
- (F) Tone wheel
- (G) Hub bolt
- (H) Hub
- (I) Socket bolt