

## 4. Engine Coolant Temperature Sensor

### A: REMOVAL

- 1) Disconnect the ground cable from battery.

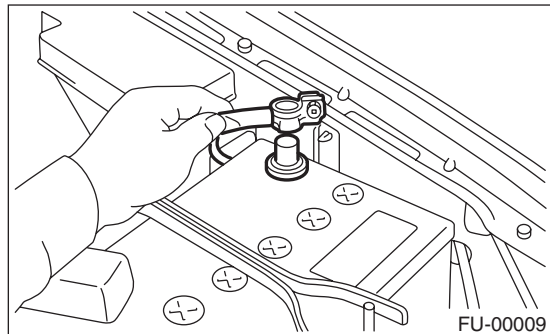

- 2) Remove the collector cover.
- 3) Remove the generator. <Ref. to SC(H4SO)-13, REMOVAL, Generator.>
- 4) Drain engine coolant. <Ref. to CO(H4SO)-16, DRAINING OF ENGINE COOLANT, REPLACEMENT, Engine Coolant.>
- 5) Disconnect the connectors from the engine coolant temperature sensor.

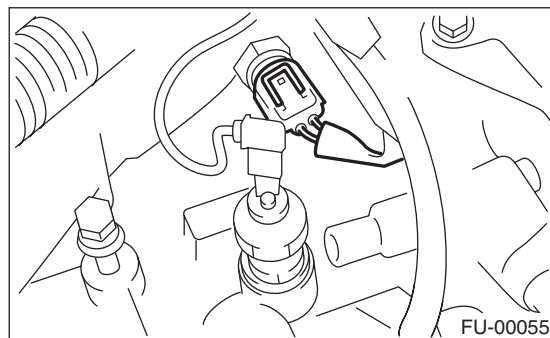

- 6) Remove the engine coolant temperature sensor.

### B: INSTALLATION

Install in the reverse order of removal.

#### **Tightening torque:**

**18 N·m (1.8 kgf-m, 13.3 ft-lb)**