

22. Fuel

A: PROCEDURE

1. RELEASING OF FUEL PRESSURE

WARNING:

Place “NO FIRE” signs near the working area.

CAUTION:

Be careful not to spill fuel.

- 1) Disconnect the connector from fuel pump relay.

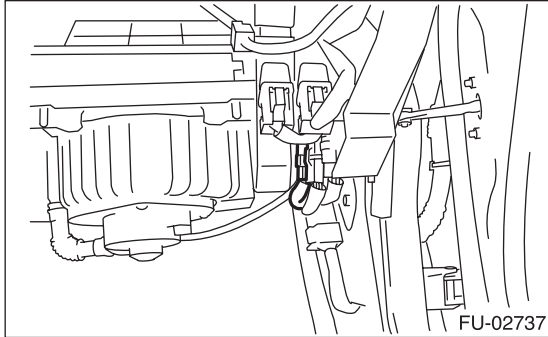

- 2) Start the engine and run it until it stalls.
- 3) After the engine stalls, crank it for five more seconds.
- 4) Turn the ignition switch to OFF.

2. DRAINING FUEL

• MODEL WITH FUEL DRAIN PLUG

WARNING:

Place “NO FIRE” signs near the working area.

CAUTION:

Be careful not to spill fuel.

- 1) Set the vehicle on a lift.
- 2) Disconnect the ground cable from battery.

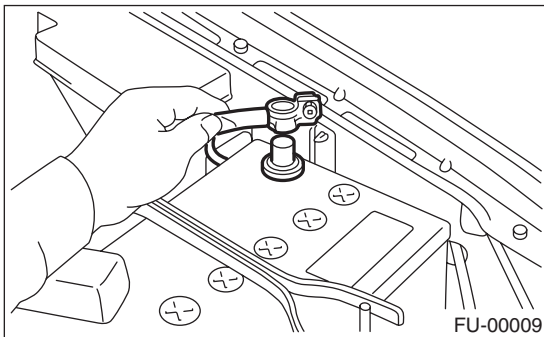

- 3) Open the fuel filler flap lid, and remove the fuel filler cap.
- 4) Lift-up the vehicle.

- 5) Drain fuel from fuel tank.

Set a container under the vehicle and remove the drain plug from the fuel tank.

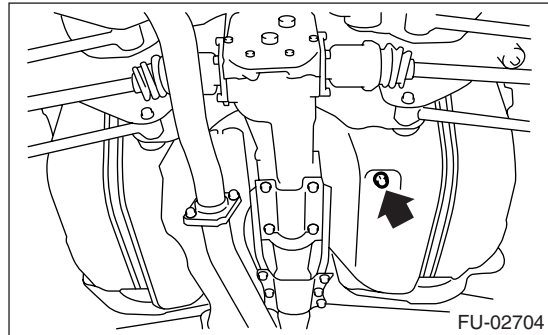

- 6) Tighten the fuel drain plugs.

NOTE:

Use a new gasket.

Tightening torque:

26 N·m (2.65 kgf-m, 19.2 ft-lb)

• MODEL WITHOUT FUEL DRAIN PLUG

WARNING:

Place “NO FIRE” signs near the working area.

CAUTION:

Be careful not to spill fuel.

- 1) Release the fuel pressure. <Ref. to FU(H4DOTC)-50, RELEASING OF FUEL PRESSURE, PROCEDURE, Fuel.>
- 2) Disconnect the ground cable from the battery.

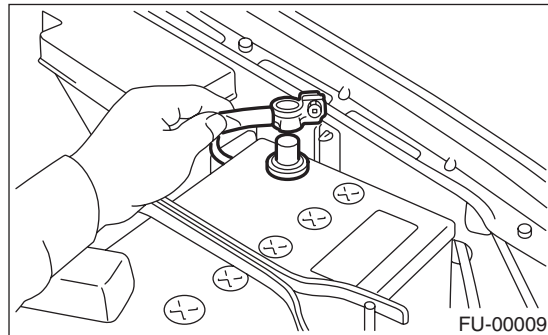

- 3) Remove the fuel pump. <Ref. to FU(H4DOTC)-58, REMOVAL, Fuel Pump.>
- 4) Drain fuel using a pump through where the fuel pump was installed.

CAUTION:

Use a petrol resistance pump or the equivalent.

- 5) Install the fuel pump. <Ref. to FU(H4DOTC)-58, INSTALLATION, Fuel Pump.>