

## 21. Fuel Pump Control Unit

### A: REMOVAL

1) Disconnect the ground cable from battery.

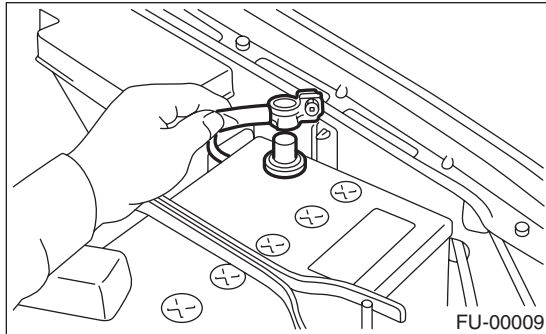

2) Remove the rear quarter trim. <Ref. to EI-43, REMOVAL, Rear Quarter Trim.>

3) Disconnect the connector from fuel pump control unit.

4) Remove the fuel pump control unit.

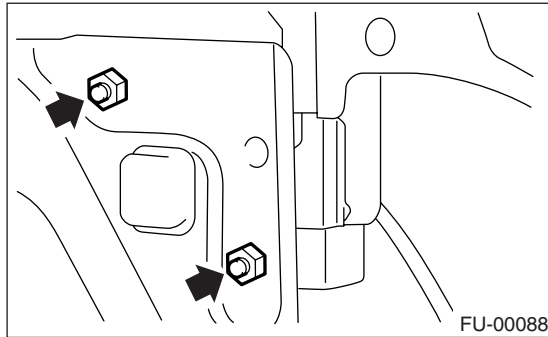

### B: INSTALLATION

Install in the reverse order of removal.