

17.Engine Control Module (ECM)

A: REMOVAL

- 1) Disconnect the ground cable from battery.

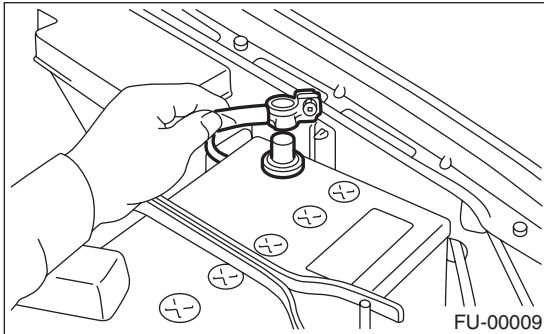

- 2) Remove the lower inner trim of the passage side.

<Ref. to EI-42, REMOVAL, Lower Inner Trim.>

- 3) Detach the floor mat of passenger's seat.

- 4) Remove the protect cover.

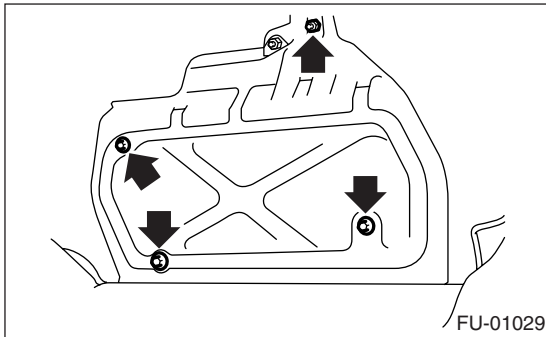

- 5) Remove the nuts (A) which hold ECM to bracket.

- 6) Remove the clip (B) from the bracket.

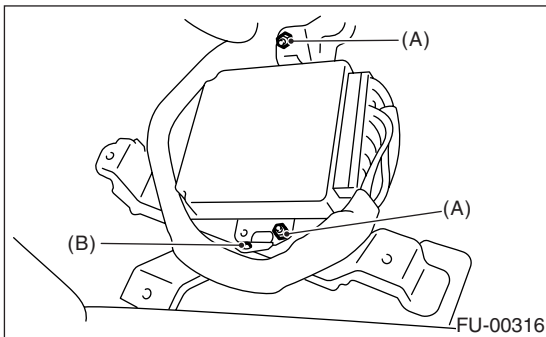

- 7) Disconnect the ECM connectors, and take out the ECM.

B: INSTALLATION

Install in the reverse order of removal.

CAUTION:

- When replacing the ECM, be careful not to use the ECM for wrong specifications to avoid any damage to fuel injection system.
- When replacing the ECM, be careful not to damage the harnesses and connectors.

Tightening torque:

5 N·m (0.5 kgf-m, 3.7 ft-lb)