

## 16.Rear Oxygen Sensor

### A: REMOVAL

- 1) Disconnect the ground cable from battery.

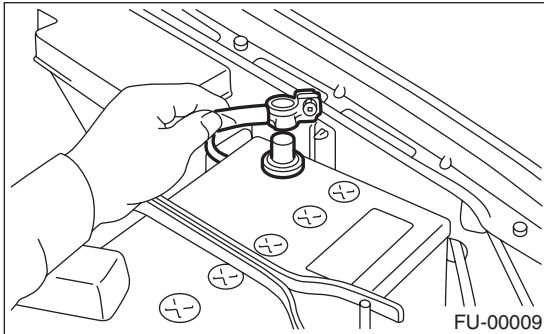

- 2) Lift-up the vehicle.

- 3) Disconnect the connector from rear oxygen sensor.

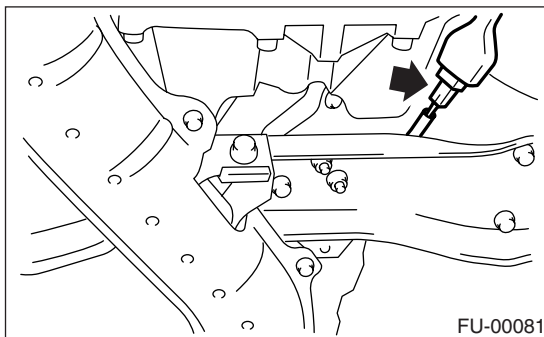

- 4) Remove the clip by pulling out from the upper side of crossmember.

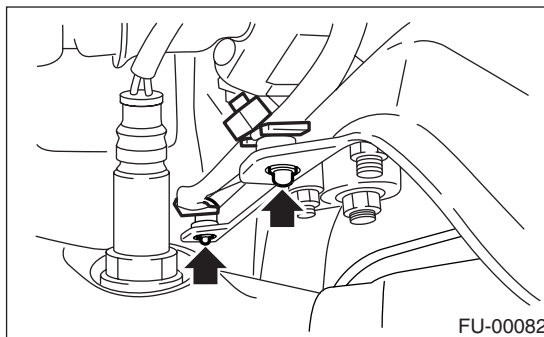

- 5) Apply spray-type lubricant to the threaded portion of rear oxygen sensor, and leave it for one minute or more.

- 6) Remove the rear oxygen sensor.

### CAUTION:

When removing the oxygen (A/F) sensor, wait until exhaust pipe cools, because it can damage the exhaust pipe.

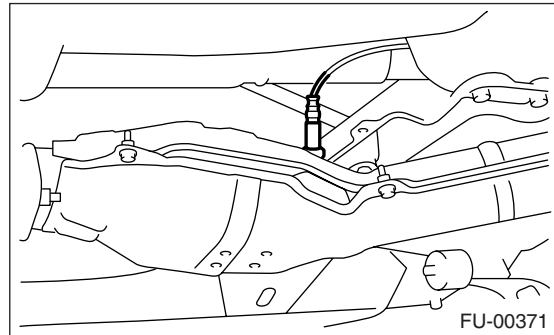

### B: INSTALLATION

- 1) Before installing rear oxygen (A/F) sensor, apply the anti-seize compound only to the threaded portion of rear oxygen (A/F) sensor. This facilitates the next removal.

### CAUTION:

Never apply anti-seize compound to protector of rear oxygen sensor.

### Anti-seize compound:

**NEVER-SEEZ NS-165 or the equivalent**

- 2) Install the rear oxygen sensor.

### Tightening torque:

**21 N·m (2.1 kgf-m, 15.2 ft-lb)**

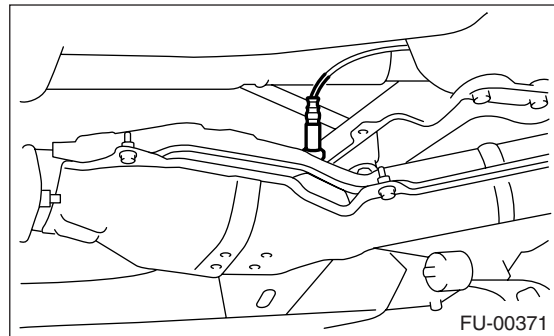

- AT model

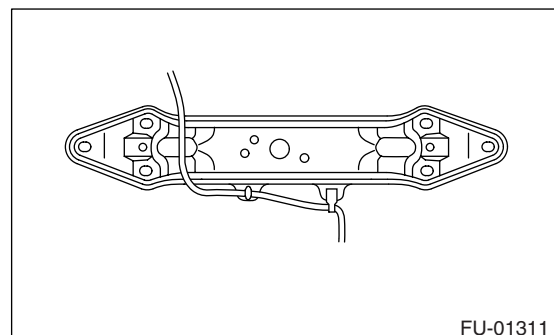

# Rear Oxygen Sensor

## FUEL INJECTION (FUEL SYSTEMS)

---

- MT model

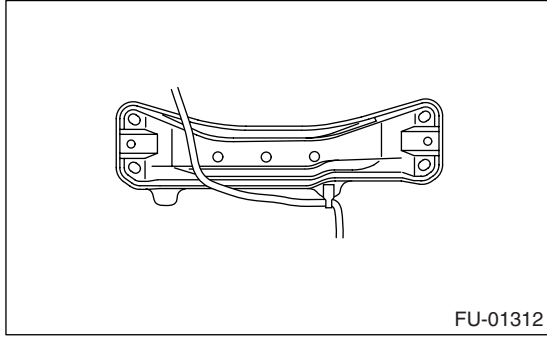

- 3) Connect the connector to rear oxygen sensor.

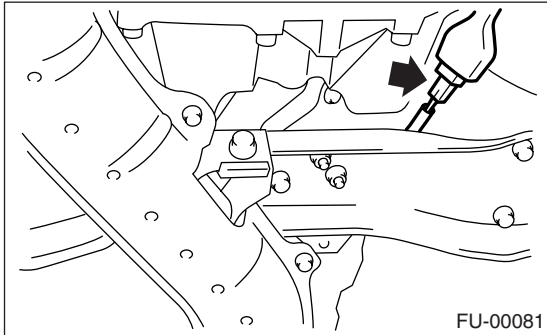

- 4) Connect the clip to the crossmember.

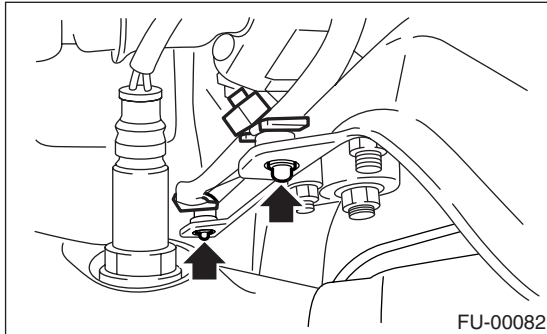

- 5) Lower the vehicle.

- 6) Connect the ground cable to battery.

