

15.Front Oxygen (A/F) Sensor

A: REMOVAL

- 1) Disconnect the ground cable from battery.

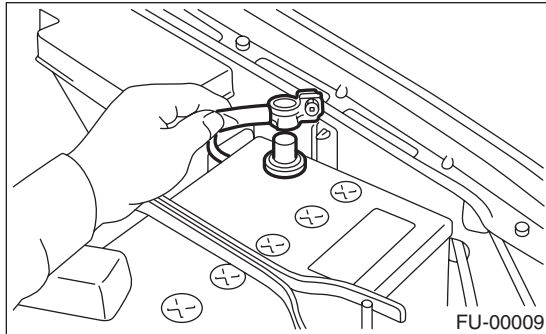

- 2) Disconnect the connector from front oxygen (A/F) sensor.

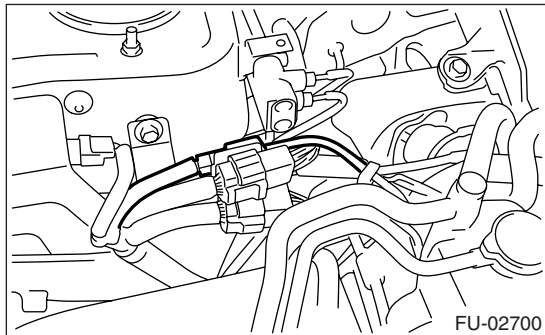

- 3) Disconnect the engine harness fixed by clip (A) from the bracket (B).

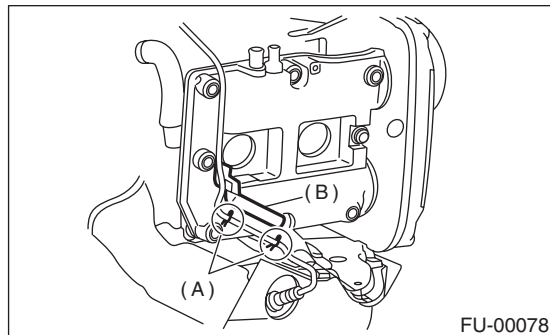

- 4) Remove the front right side wheel.
- 5) Lift-up the vehicle.
- 6) Remove the service hole cover.

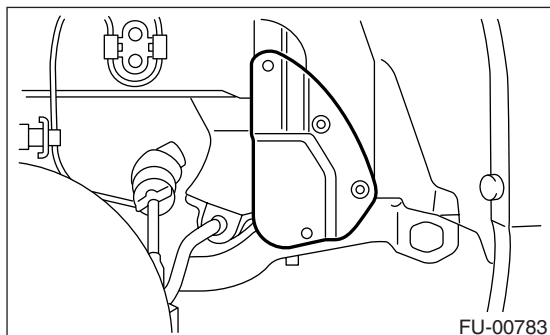

- 7) Apply spray-type lubricant to the threaded portion of front oxygen (A/F) sensor, and leave it for one minute or more.

- 8) Remove the front oxygen (A/F) sensor.

CAUTION:

When removing the oxygen (A/F) sensor, wait until exhaust pipe cools, otherwise it will damage the exhaust pipe.

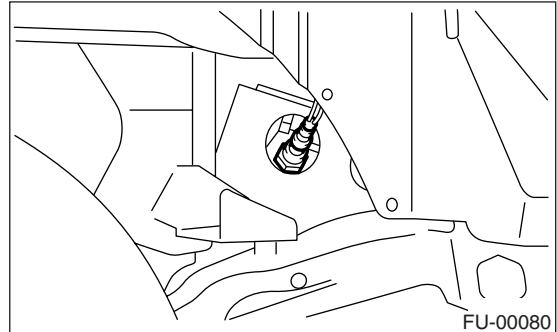

B: INSTALLATION

- 1) Before installing front oxygen (A/F) sensor, apply the anti-seize compound only to the threaded portion of front oxygen (A/F) sensor. This facilitates the next removal.

Anti-seize compound:

NEVER-SEEZ NS-165 or the equivalent

CAUTION:

Never apply anti-seize compound to protector of front oxygen (A/F) sensor.

- 2) Install the front oxygen (A/F) sensor.

Tightening torque:

30 N·m (3.1 kgf-m, 22.1 ft-lb)

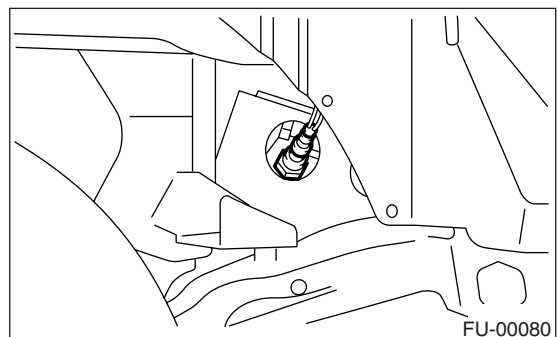

Front Oxygen (A/F) Sensor

FUEL INJECTION (FUEL SYSTEMS)

3) Install the service hole cover.

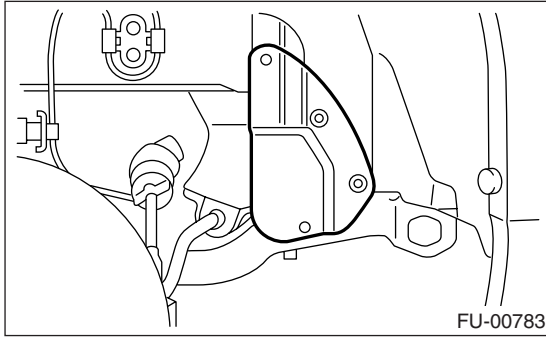

4) Lower the vehicle.

5) Install the front right side wheel.

6) Connect the engine harness to the bracket (B) using the clip (A).

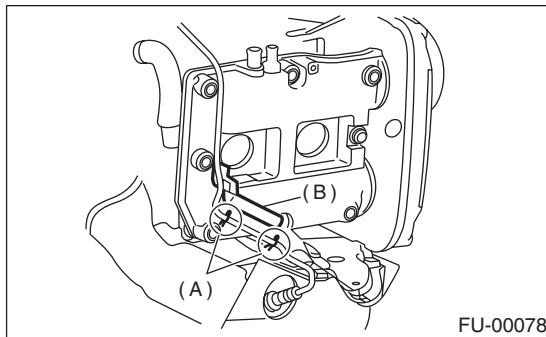

7) Connect the connector of front oxygen (A/F) sensor.

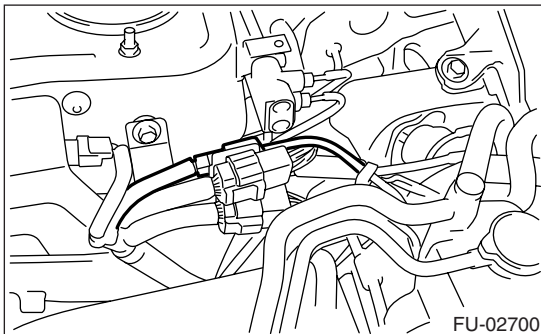

8) Connect the ground cable to battery.

