

# Engine Coolant Temperature Sensor

FUEL INJECTION (FUEL SYSTEMS)

---

## 4. Engine Coolant Temperature Sensor

### A: REMOVAL

1) Disconnect the ground cable from battery.

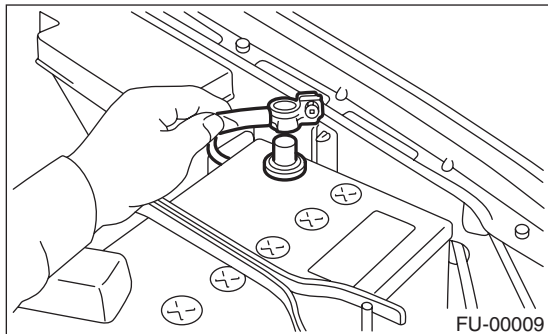

2) Remove the generator. <Ref. to SC(H4SO)-13, REMOVAL, Generator.>

3) Disconnect the connectors from the engine coolant temperature sensor.

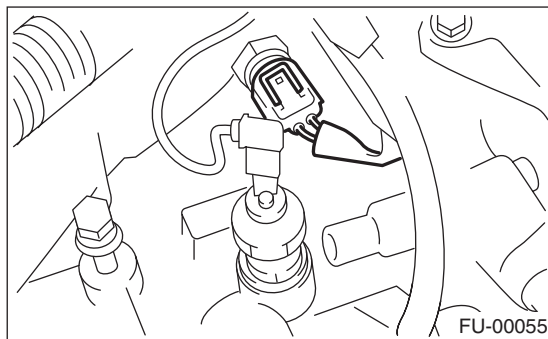

4) Remove the engine coolant temperature sensor.

### B: INSTALLATION

Install in the reverse order of removal.

NOTE:

Use a new gasket.

**Tightening torque:**

**18 N·m (1.8 kgf-m, 13.0 ft-lb)**