

# Fuel Pump

## FUEL INJECTION (FUEL SYSTEMS)

### 24. Fuel Pump

#### A: REMOVAL

##### WARNING:

Place “NO FIRE” signs near the working area.

##### CAUTION:

Be careful not to spill fuel.

##### NOTE:

Fuel pump assembly consists of fuel pump and fuel level sensor.

1) Release the fuel pressure.

<Ref. to FU(H4SO)-44, RELEASING OF FUEL PRESSURE, PROCEDURE, Fuel.>

2) Disconnect the ground cable from battery.

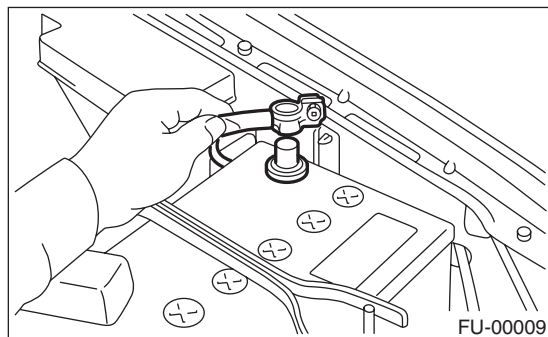

3) Open the fuel filler flap lid, and remove the fuel filler cap.

4) Remove the luggage floor mat. <Ref. to EI-48, REMOVAL, Luggage Floor Mat.>

5) Remove the service hole cover.

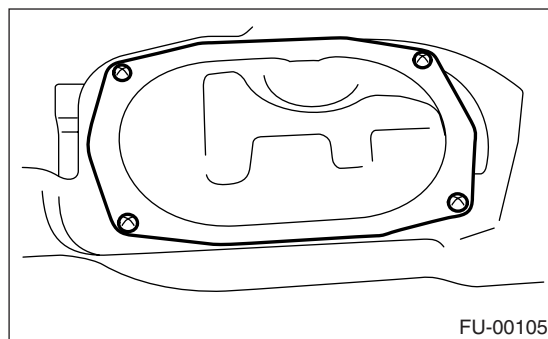

6) Disconnect the connector from fuel pump.

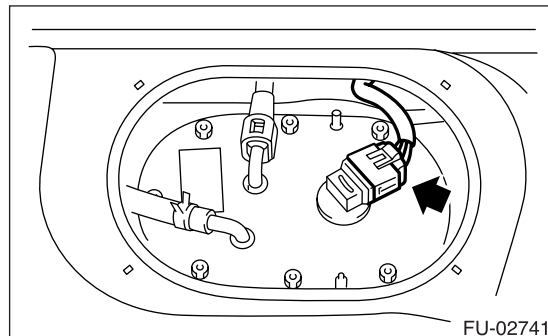

7) Disconnect the quick connector and then disconnect the fuel delivery hose. <Ref. to FU(H4SO)-59, REMOVAL, Fuel Delivery, Return and Evaporation Lines.>

8) Move the clips, and disconnect the jet pump hose (A).

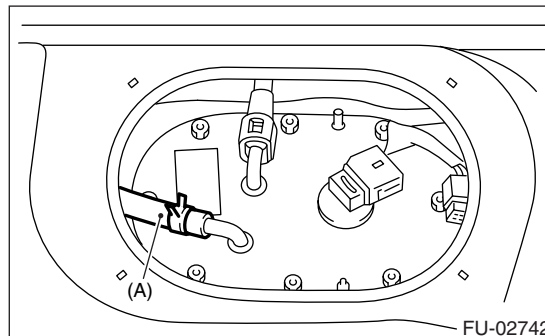

9) Remove the nuts which install fuel pump assembly onto fuel tank.

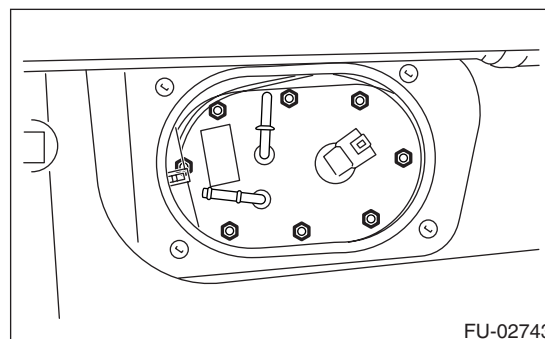

10) Pull out the evaporation assembly from the fuel tank.

## B: INSTALLATION

Install in the reverse order of removal. Perform the following.

### NOTE:

Use a new gasket or retainer.

1. Make sure the sealing portion is free from fuel or foreign matter before installation.
2. Tighten the nuts in alphabetical sequence as shown in the figure to the specified torque.

### ***Tightening torque:***

***4.4 N·m (0.45 kgf-m, 3.3 ft-lb)***

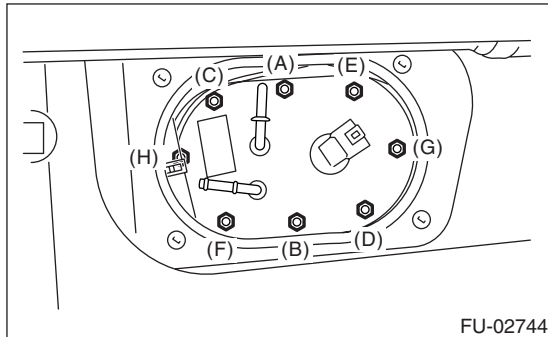

## C: INSPECTION

Connect the lead harness to the connector terminal of fuel pump, and apply the battery power supply to check whether the pump operates.

### WARNING:

- Wipe off fuel completely.
- Keep the battery as far apart from fuel pump as possible.
- Be sure to turn the battery supply ON and OFF on the battery side.
- Do not run the fuel pump for a long time under non-load condition.

