

## 2. Throttle Body

### A: REMOVAL

1) Disconnect the ground cable from battery.

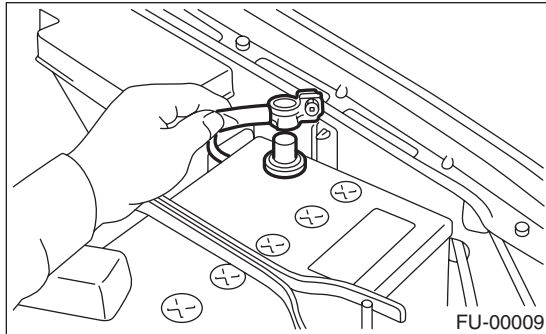

2) Remove the air intake chamber. <Ref. to IN(H4SO)-6, REMOVAL, Air Intake Chamber.>

3) Disconnect the connectors from throttle position sensor and manifold absolute pressure sensor.

4) Disconnect the engine coolant hoses from throttle body.

5) Remove the bolt which installs throttle body on intake manifold.

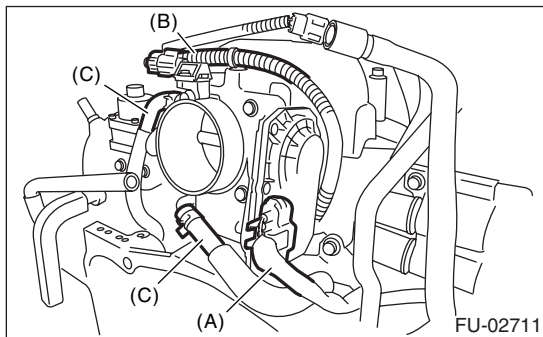

- (A) Throttle position sensor
- (B) Manifold absolute pressure sensor
- (C) Engine coolant hose

### B: INSTALLATION

Install in the reverse order of removal.

NOTE:

Use a new gasket.

**Tightening torque:**

**8 N·m (0.8 kgf-m, 5.8 ft-lb)**