

### 19. Fuel Pump Relay

#### A: REMOVAL

- 1) Disconnect the ground cable from battery.

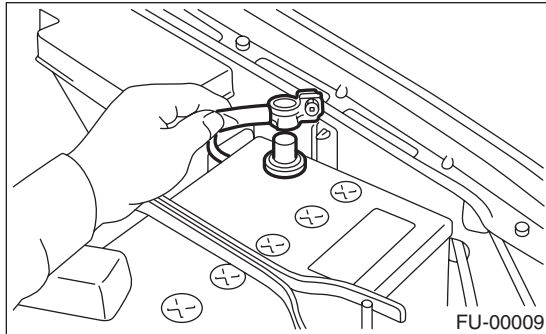

- 2) Remove the glove box. <Ref. to EI-35, REMOVAL, Glove Box.>
- 3) Remove the passenger's side front side sill cover.
- 4) Disconnect the connector from fuel pump relay.

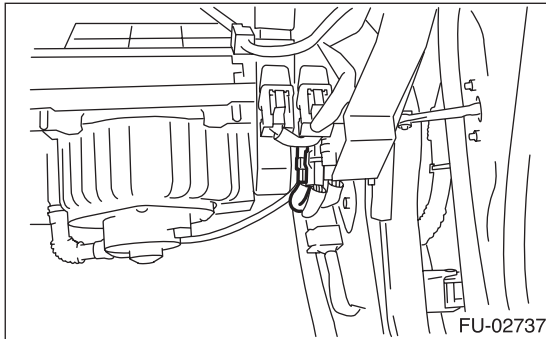

- 5) Remove the fuel pump relay from the mounting bracket.

#### B: INSTALLATION

Install in the reverse order of removal.