

Rear Oxygen Sensor

FUEL INJECTION (FUEL SYSTEMS)

16.Rear Oxygen Sensor

A: REMOVAL

- 1) Disconnect the ground cable from battery.

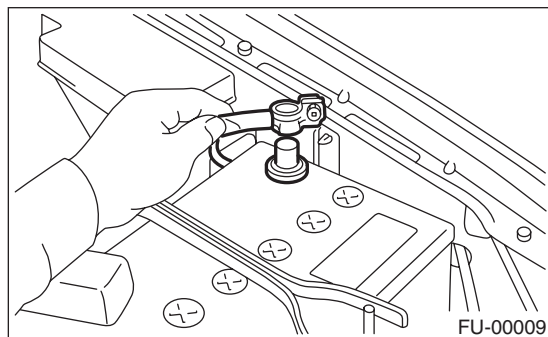

- 2) Remove the clip fastening the harness and disconnect the rear oxygen (A/F) sensor connector.

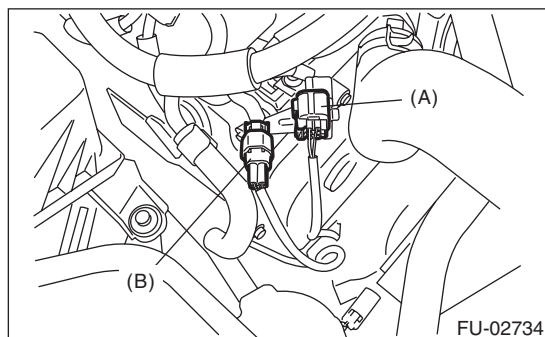

- (A) Front oxygen (A/F) sensor connector
(B) Rear oxygen sensor connector

- 3) Lift-up the vehicle.
- 4) Remove the under cover.
- 5) Apply spray-type lubricant to the threaded portion of rear oxygen sensor, and leave it for one minute or more.
- 6) Remove the rear oxygen sensor.

CAUTION:

When removing the rear oxygen (A/F) sensor, wait until exhaust pipe cools, because it can damage the exhaust pipe.

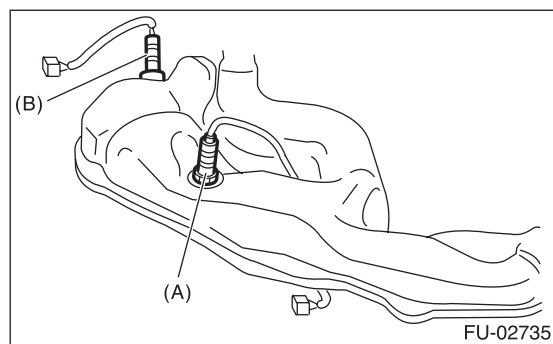

- (A) Front oxygen (A/F) sensor
(B) Rear oxygen sensor

B: INSTALLATION

- 1) Before installing rear oxygen sensor, apply the anti-seize compound only to the threaded portion of rear oxygen sensor to make the next removal easier.

CAUTION:

Never apply anti-seize compound to the protector of rear oxygen sensor.

Anti-seize compound:

NEVER-SEEZ NS-165 or the equivalent

- 2) Install the rear oxygen sensor.

Tightening torque:

21 N·m (2.1 kgf-m, 15.2 ft-lb)

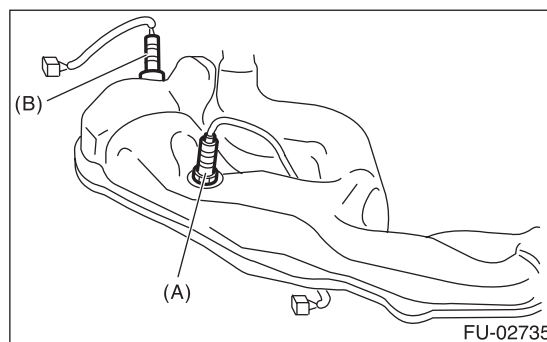

- (A) Front oxygen (A/F) sensor
(B) Rear oxygen sensor

- 3) Install the under cover.
- 4) Lower the vehicle.
- 5) Connect the connector to rear oxygen sensor and mount the harness clips to the bracket for fastening.

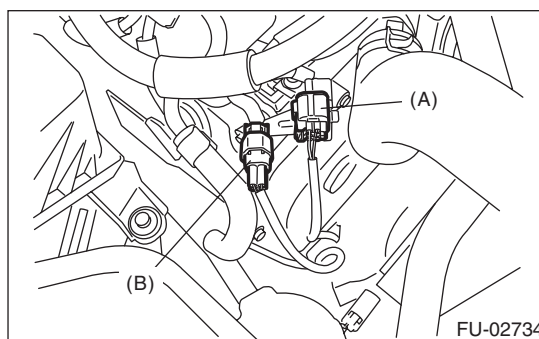

- (A) Front oxygen (A/F) sensor connector
(B) Rear oxygen sensor connector

Rear Oxygen Sensor

FUEL INJECTION (FUEL SYSTEMS)

6) Connect the ground cable to battery.

