

## 16. Cam Sprocket

### A: REMOVAL

- 1) Remove the V-belts. <Ref. to ME(H4SO)-37, REMOVAL, V-belt.>
  - 2) Remove the crank pulley. <Ref. to ME(H4SO)-39, REMOVAL, Crank Pulley.>
  - 3) Remove the timing belt cover. <Ref. to ME(H4SO)-40, REMOVAL, Timing Belt Cover.>
  - 4) Remove the timing belt. <Ref. to ME(H4SO)-41, REMOVAL, Timing Belt.>
  - 5) Remove the camshaft position sensor. <Ref. to FU(H4SO)-24, REMOVAL, Camshaft Position Sensor.>
  - 6) Remove the cam sprocket No. 2. To lock the camshaft, use the ST.
- ST 18231AA010 CAM SPROCKET WRENCH

#### NOTE:

CAM SPROCKET WRENCH (499207100) can also be used.

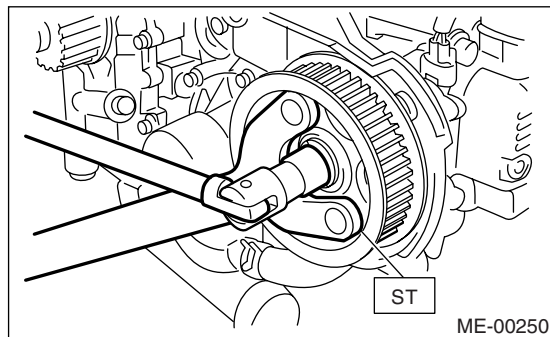

- 7) Remove the cam sprocket No. 1. To lock the camshaft, use the ST.
- ST 499207400 CAM SPROCKET WRENCH

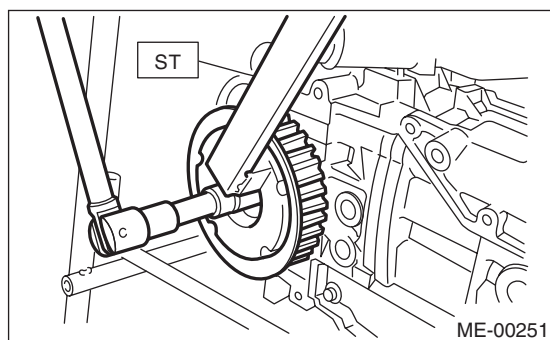

### B: INSTALLATION

- 1) Install the cam sprocket No. 1. To lock the camshaft, use the ST.
- ST 499207400 CAM SPROCKET WRENCH

#### Tightening torque:

**78 N·m (8.0 kgf-m, 57.9 ft-lb)**

#### NOTE:

Do not confuse left and right side cam sprockets during installation. Identify by L or R markings.

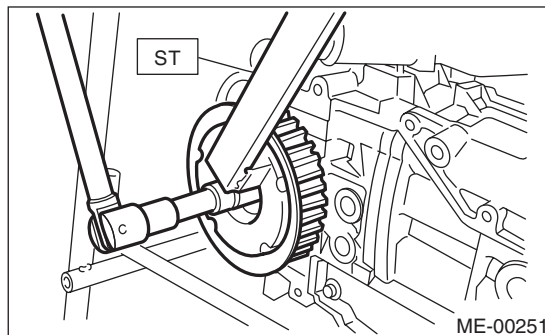

- 2) Install the cam sprocket No. 2. To lock the camshaft, use the ST.
- ST 18231AA010 CAM SPROCKET WRENCH

#### NOTE:

CAM SPROCKET WRENCH (499207100) can also be used.

#### Tightening torque:

**78 N·m (8.0 kgf-m, 57.9 ft-lb)**

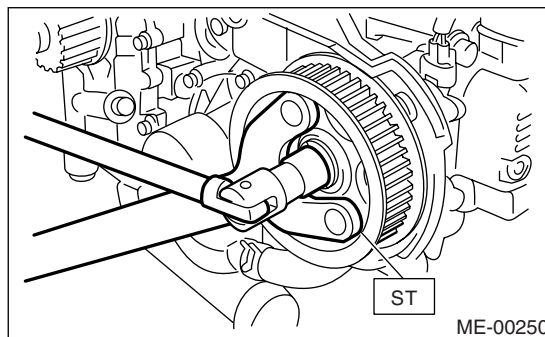

- 3) Install the camshaft position sensor. <Ref. to FU(H4SO)-24, INSTALLATION, Camshaft Position Sensor.>
- 4) Install the timing belt. <Ref. to ME(H4SO)-42, INSTALLATION, Timing Belt.>
- 5) Install the timing belt cover. <Ref. to ME(H4SO)-40, INSTALLATION, Timing Belt Cover.>
- 6) Install the crank pulley. <Ref. to ME(H4SO)-39, INSTALLATION, Crank Pulley.>
- 7) Install the V-belts. <Ref. to ME(H4SO)-37, INSTALLATION, V-belt.>

### C: INSPECTION

- 1) Check the cam sprocket teeth for abnormal wear and scratches.
- 2) Make sure there is no free play between cam sprocket and key.
- 3) Check the cam sprocket protrusion used for sensor for damage and contamination of foreign matter.