

7. Oil Pipe

A: REMOVAL

NOTE:

The oil pipe is installed on turbo models.

- 1) Remove the collector cover.
- 2) Disconnect the ground cable from battery.

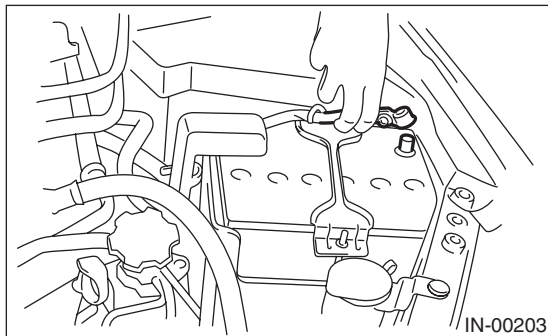

- 3) Remove the intake manifold. <Ref. to FU(H4DOTC)-14, REMOVAL, Intake Manifold.>
- 4) Remove the radiator main fan and radiator sub fan. <Ref. to CO(H4SO)-32, REMOVAL, Radiator Main Fan and Fan Motor.> <Ref. to CO(H4SO)-39, REMOVAL, Radiator Sub Fan and Fan Motor.>
- 5) Remove the V-belts. <Ref. to ME(H4DOTC)-38, REMOVAL, V-belt.>
- 6) Remove the crank pulley. <Ref. to ME(H4DOTC)-40, REMOVAL, Crank Pulley.>
- 7) Remove the timing belt cover. <Ref. to ME(H4DOTC)-41, REMOVAL, Timing Belt Cover.>
- 8) Remove the timing belt. <Ref. to ME(H4DOTC)-42, TIMING BELT, REMOVAL, Timing Belt.>
- 9) Remove the cam sprocket LH. <Ref. to ME(H4DOTC)-50, REMOVAL, Cam Sprocket.>
- 10) Remove the belt cover No. 2 LH.

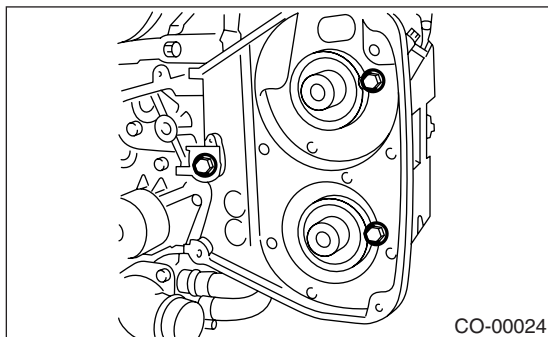

- 11) Remove the oil pipe.

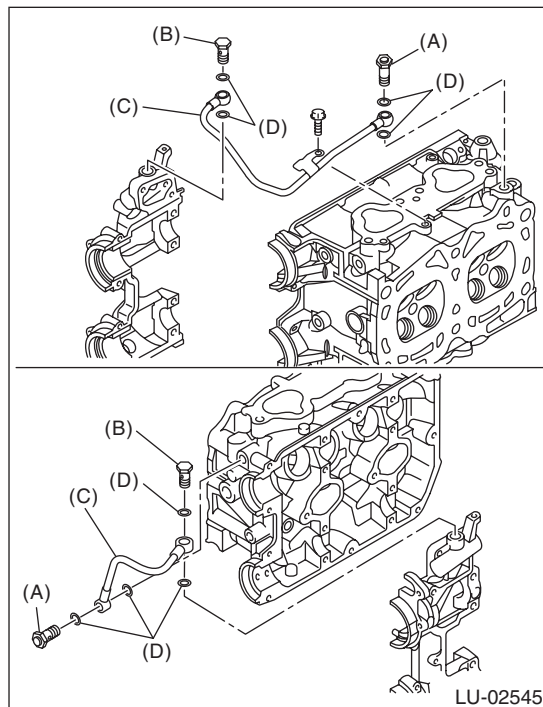

- (A) Union screw with filter (with protrusion)
- (B) Union screw without filter (without protrusion)
- (C) Oil pipe
- (D) Gasket

B: INSTALLATION

1) Inspect the union screw with filter. <Ref. to LU(H4SO)-24, INSPECTING UNION SCREW WITH FILTER, INSPECTION, Oil Pipe.>

2) Install the oil pipe.

NOTE:

- Make sure not to mix up the union screws with filter and without filter as their installation positions are different.
- Use a new gasket.

Tightening torque:

T1: 8 N·m (0.8 kgf-m, 5.9 ft-lb)

T2: 29 N·m (3.0 kgf-m, 21.4 ft-lb)

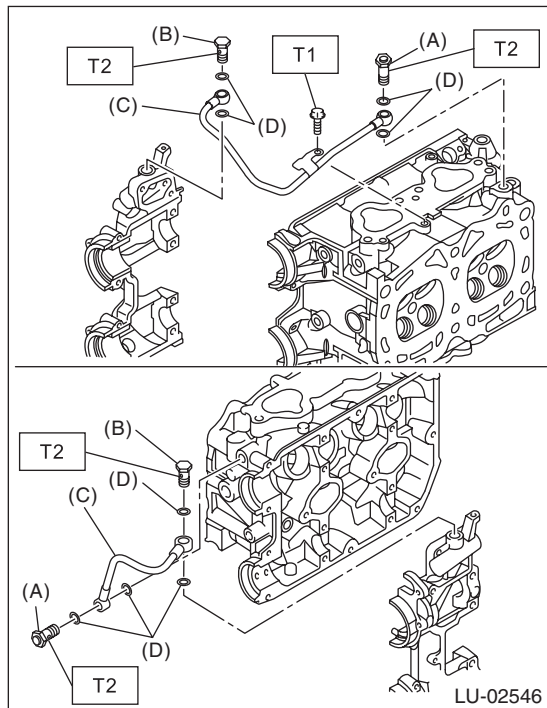

- (A) Union screw with filter (with protrusion)
 (B) Union screw without filter (without protrusion)
 (C) Oil pipe
 (D) Gasket

3) Install the belt cover No. 2 LH.

Tightening torque:

5 N·m (0.5 kgf-m, 3.7 ft-lb)

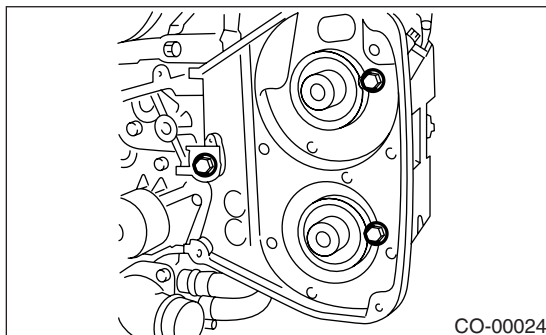

4) Install the cam sprocket LH. <Ref. to ME(H4DOTC)-50, INSTALLATION, Cam Sprocket.>

5) Install the timing belt. <Ref. to ME(H4DOTC)-45, TIMING BELT, INSTALLATION, Timing Belt.>

6) Install the timing belt cover. <Ref. to ME(H4DOTC)-41, INSTALLATION, Timing Belt Cover.>

7) Install the crank pulley. <Ref. to ME(H4DOTC)-40, INSTALLATION, Crank Pulley.>

8) Install the V-belts. <Ref. to ME(H4DOTC)-38, INSTALLATION, V-belt.>

9) Install the radiator main fan and the radiator sub fan. <Ref. to CO(H4SO)-35, INSTALLATION, Radiator Main Fan and Fan Motor.> <Ref. to CO(H4SO)-39, INSTALLATION, Radiator Sub Fan and Fan Motor.>

10) Install the intake manifold. <Ref. to FU(H4DOTC)-17, INSTALLATION, Intake Manifold.>

11) Connect the ground cable to battery.

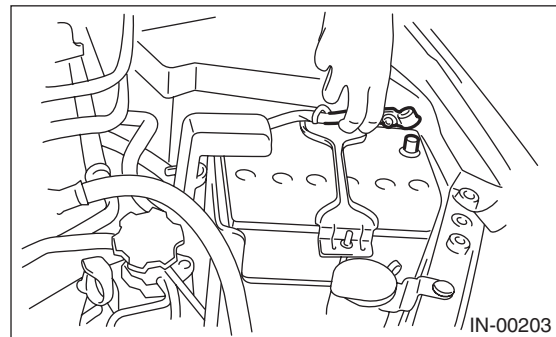

12) Install the collector cover.

C: INSPECTION

1. INSPECTING UNION SCREW WITH FILTER

Check the filter part of union screw for clogging or damage, and if defective, replace the union screw with filter with a new part.

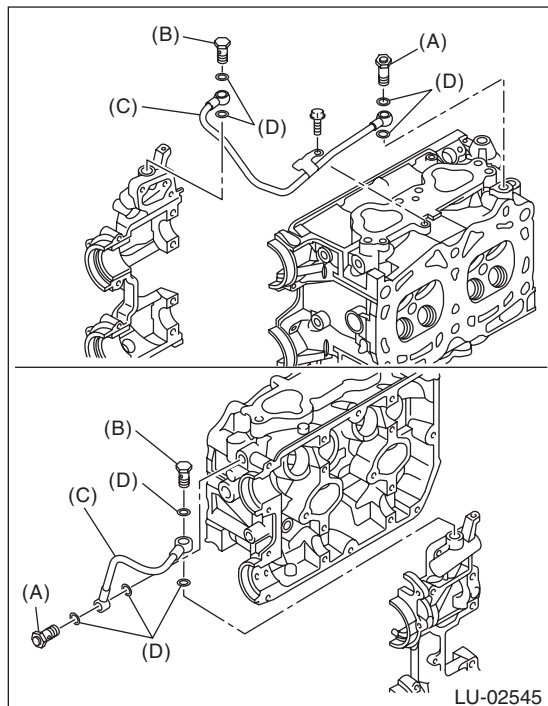

- (A) Union screw with filter (with protrusion)
- (B) Union screw without filter (without protrusion)
- (C) Oil pipe
- (D) Gasket

2. OTHER INSPECTIONS

- 1) Check that the oil pipe and union screw have no deformation, cracks and other damages.
- 2) Check that there are no oil leaks or oil oozing from the oil pipe attachment section.