

2. Front Seat

A: REMOVAL

1. DRIVER'S SEAT (STANDARD SEAT)

1) Disconnect the battery ground cable from the battery.

WARNING:

Perform airbag system maintenance at least 20 seconds after removing the battery negative terminal. If work is started within 20 seconds, there is a danger of the airbag system backup power deploying the airbag.

2) While pressing the headrest lock button, remove the headrest.

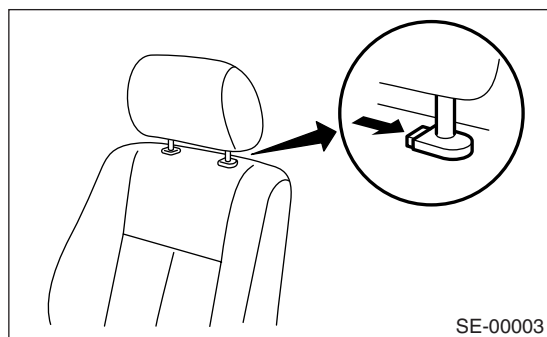

3) Tilt the backrest forward.

4) Move the seat to full front end.

5) Remove the bolt cover at rear end of the slide rail.

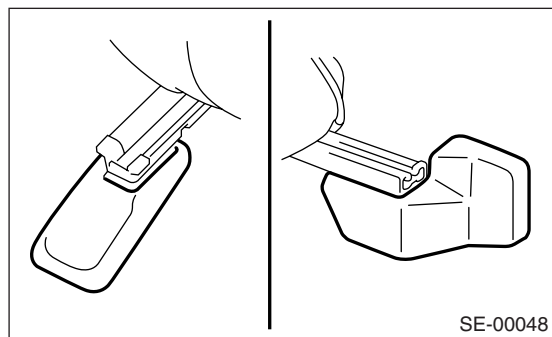

6) Remove the two bolts at rear side of seat rail.

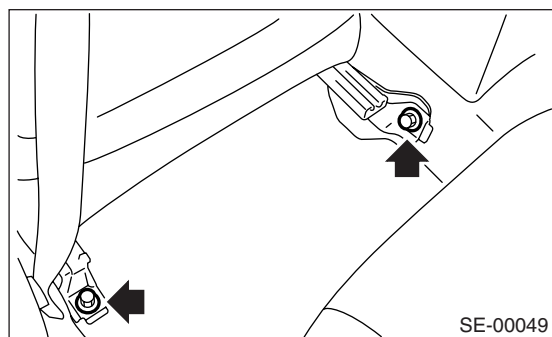

7) Move the seat to full rear end.

8) Remove the two bolts at the front side of the seat rail.

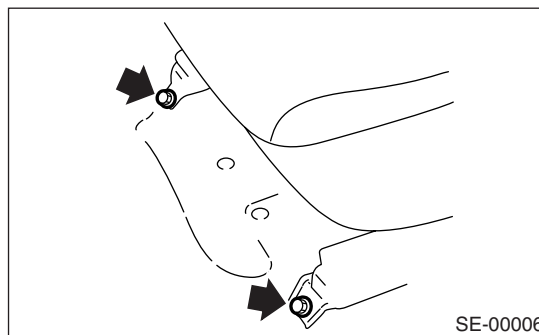

9) Disconnect the connector under the seat.

- Side airbag connector
- Seat belt warning light connector
- Buckle switch connector
- Position sensor connector

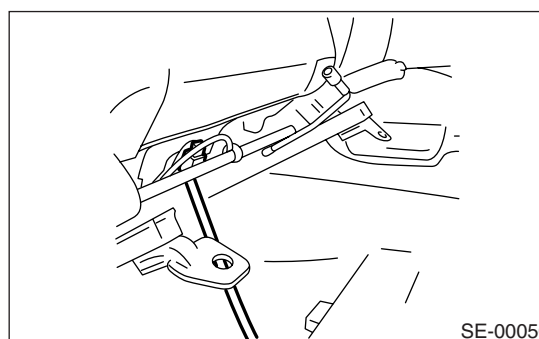

10) Remove the front seat from vehicle.

2. DRIVER'S SEAT (POWER SEAT)

1) While pressing the headrest lock button, remove the headrest.

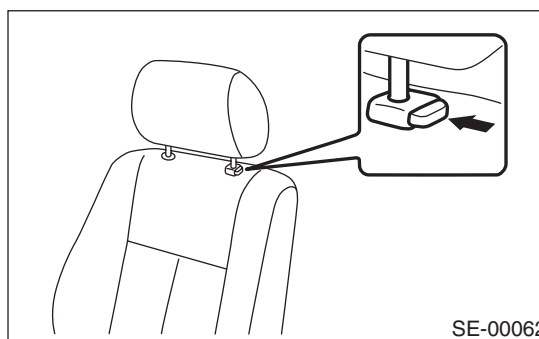

2) Tilt the backrest forward.

3) Move the seat to the full forward position.

- 4) Remove the bolt cover at rear end of the slide rail.

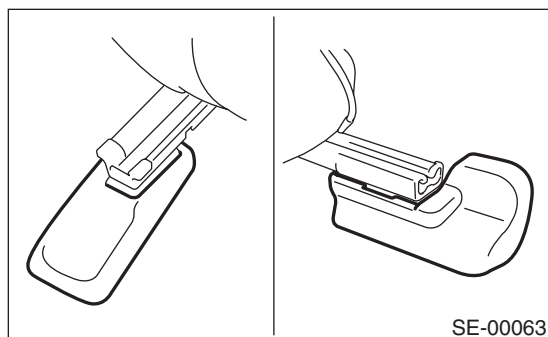

- 5) Remove the two bolts at the rear side of the seat rail.

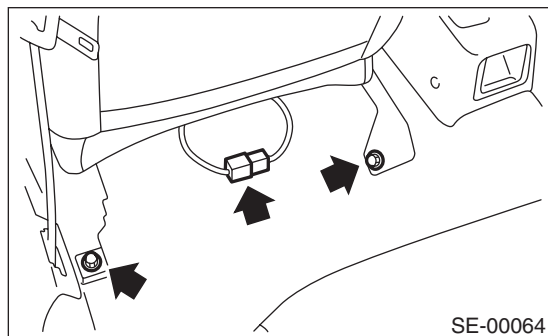

- 6) Move the seat to the full rearward position.

- 7) Remove the two bolts at the front side of the seat rail.

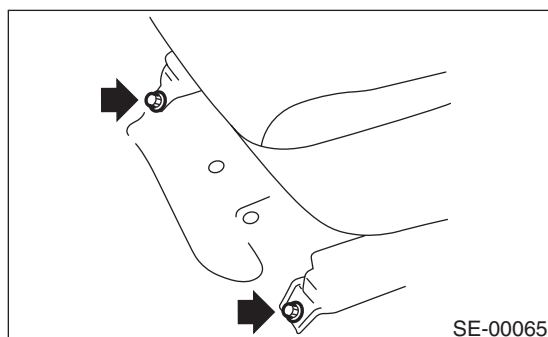

- 8) Disconnect the battery ground cable from the battery.

WARNING:

Perform airbag system maintenance at least 20 seconds after removing the battery negative terminal. If work is started within 20 seconds, there is a danger of the airbag system backup power deploying the airbag.

- 9) Disconnect the connector under the seat.

- Side airbag connector
- Buckle switch connector
- Position sensor connector

- 10) Disconnect the integrated connector.

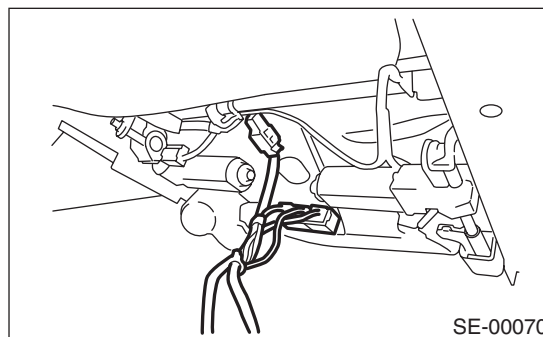

- 11) Remove the front seat from vehicle.

CAUTION:

When removing the seat from the vehicle, take care not to damage the body, seat or trim.

3. PASSENGER'S SEAT (VEHICLES BEFORE V.I.N. 733000)

CAUTION:

- If the passenger seat is removed from the vehicle or even one attachment bolt is removed from the passenger seat, make sure to perform system adjustment of the occupant detection system after attaching the seat. <Ref. to OD(diag)-13, SYSTEM CALIBRATION, OPERATION, Subaru Select Monitor.>

Failure to do so may cause improper activation of the passenger's airbag.

- On the passenger seat, never disassemble the seat cushion frame assembly and the slide rail, or remove the occupant detection control module or occupant detection sensors, or disconnect the harness connectors. These are all a part of the seat frame assembly.

- When removing the backrest, read the data of the occupant detection sensor with Subaru Select Monitor before removing the seat. <Ref. to OD(diag)-13, SENSOR DATA READ, OPERATION, Subaru Select Monitor.>

- 1) Disconnect the battery ground cable from the battery.

WARNING:

Perform airbag system maintenance at least 20 seconds after removing the battery negative terminal. If work is started within 20 seconds, there is a danger of the airbag system backup power deploying the airbag.

Front Seat

SEATS

- 2) Remove the headrest.

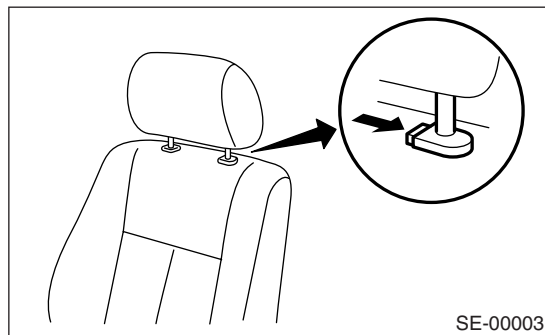

- 3) Tilt the backrest forward, and move the seat forward.

- 4) Remove the rear bolt cover, and then remove the rear side of slide rail.

- 5) Move the seat backward, remove the front bolt cover, and then remove the bolt at the front side of slide rail.

- 6) Disconnect all the connectors of connector holder in the backside of seat cushion.

- Harness connector of occupant detection control module
- Side airbag connector
- SSM connector
- Seat heater connector (model with seat heater)

- 7) Remove the seat belt anchor cover.

NOTE:

It will be easier to work if the seat is leaned back.

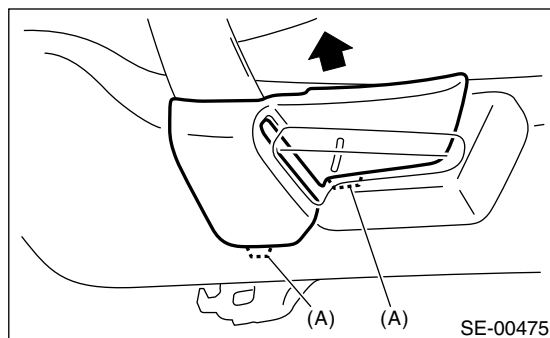

(A) Claw section

- 8) Loosen the bolt and remove the seat belt anchor.

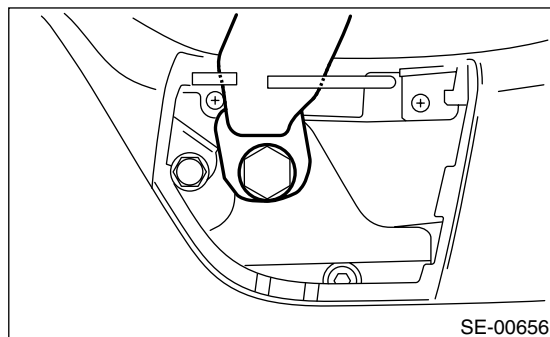

- 9) Remove the seat from vehicle.

4. PASSENGER'S SEAT (VEHICLES AFTER V.I.N. 733001)

CAUTION:

Refer to "CAUTION" of "General Description" before starting the work. <Ref. to SE-7, CAUTION, General Description.>

- 1) Disconnect the battery ground cable from the battery.

WARNING:

Perform airbag system maintenance at least 20 seconds after removing the battery negative terminal. If work is started within 20 seconds, there is a danger of the airbag system backup power deploying the airbag.

- 2) Remove the headrest.

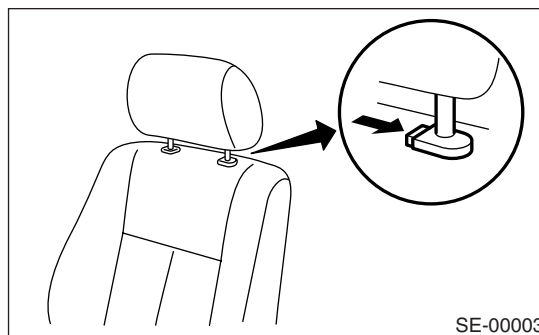

- 3) Tilt the backrest forward, and move the seat forward.

- 4) Remove the rear bolt cover, and then remove the rear side of slide rail.

- 5) Move the seat backward, remove the front bolt cover, and then remove the bolt at the front side of slide rail.

- 6) Disconnect all the connectors of connector holder in the backside of seat cushion.

- Harness connector of occupant detection control module
- Side airbag connector
- Seat heater connector (model with seat heater)

- 7) Remove the seat from vehicle.

B: INSTALLATION

Install in the reverse order of removal.

NOTE:

Tighten the slide rail installing bolt gradually in several steps to the specified torque in the order as shown in the figure.

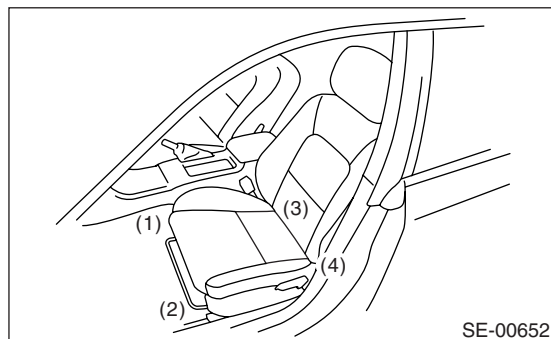

CAUTION:

1. Driver's seat

After installing the driver's seat, use the Subaru Select Monitor to confirm that the seat position sensor LH is operating properly. <Ref. to AB(diag)-27, DISPLAY OF STATUS INFORMATION, OPERATION, Subaru Select Monitor.>

2. Passenger's seat (vehicles before V.I.N. 733000)

Be sure to perform system calibration for the occupant detection system after passenger's seat installation. <Ref. to OD(diag)-13, SYSTEM CALIBRATION, OPERATION, Subaru Select Monitor.>

Failure to do so may cause improper activation of the passenger's airbag.

3. Passenger's seat (vehicles after V.I.N. 733001)

Be sure to perform system calibration for the occupant detection system after seat installation. <Ref. to OD(TYPE B)(diag)-18, SYSTEM CALIBRATION (REZEROING), OPERATION, Subaru Select Monitor.>

Failure to do so may cause improper operation of the occupant detection system.

Tightening torque:

Refer to "COMPONENT" of "General Description". <Ref. to SE-2, FRONT SEAT, COMPONENT, General Description.>

C: DISASSEMBLY

1. DRIVER'S SEAT

Standard seat

1) Remove the seat from vehicle. <Ref. to SE-8, REMOVAL, Front Seat.>

2) Remove the reclining lever cover and reclining hinge cover.

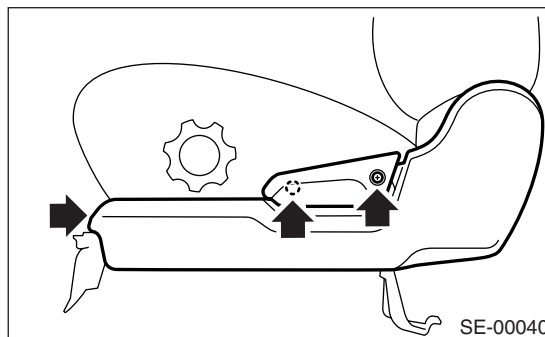

3) Loosen the screws to remove hinge cover.

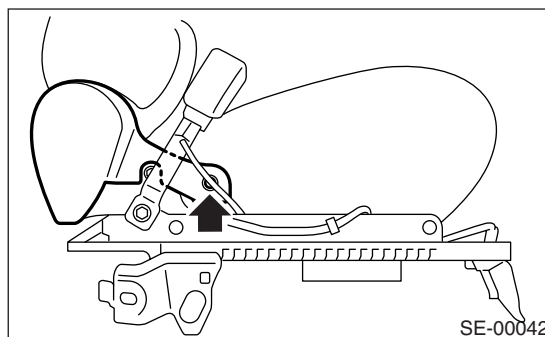

4) Remove the two bolts from the reclining hinge on each left and right side.

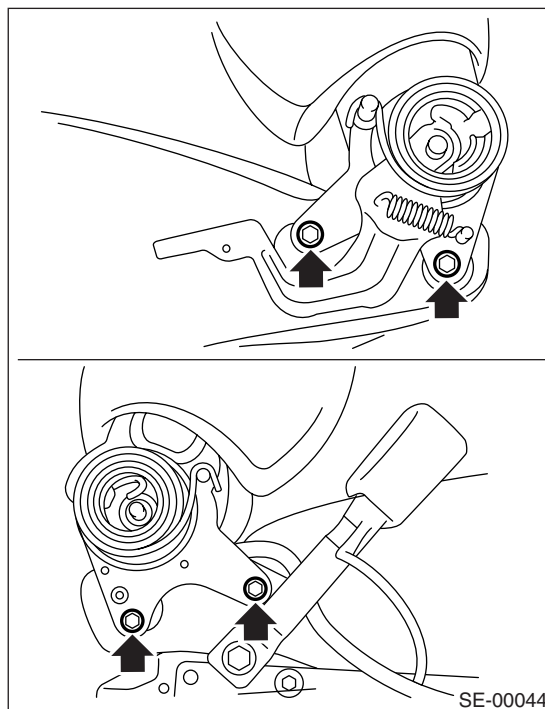

Front Seat

SEATS

5) Remove the hook at bottom of seat backrest.

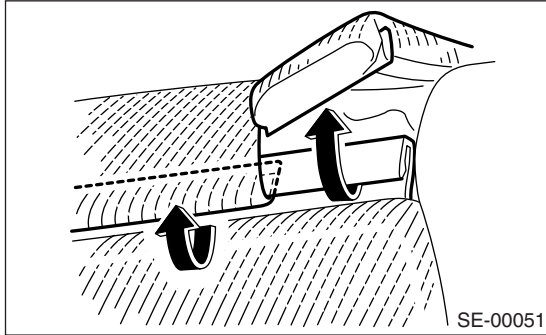

6) Open the fastener at the rear side of backrest.

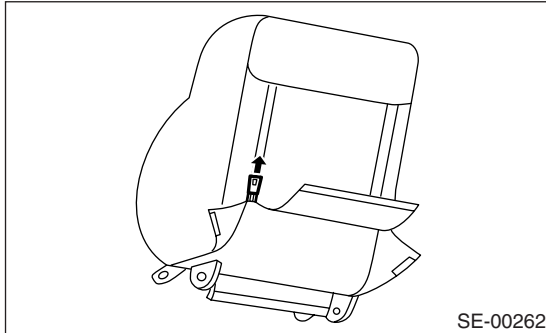

7) Remove the hog rings (A) on the front side of backrest from the backrest frame. (Seat with side airbag)

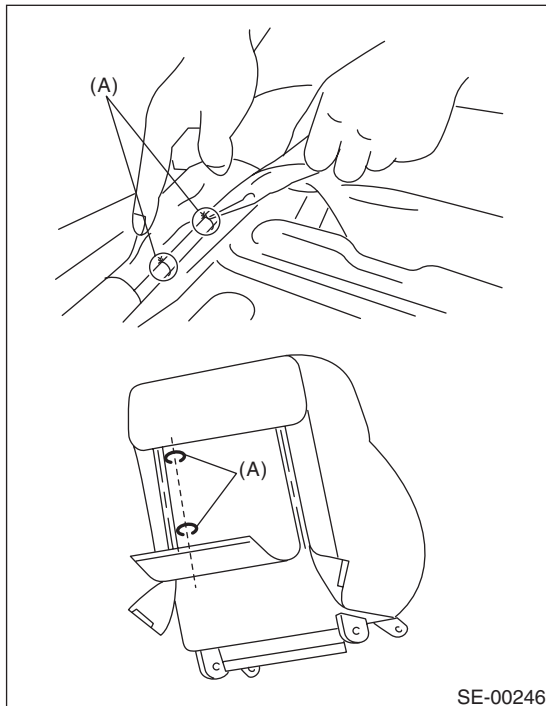

8) Remove the hog ring (A) which secures the backrest cover and backrest pad.

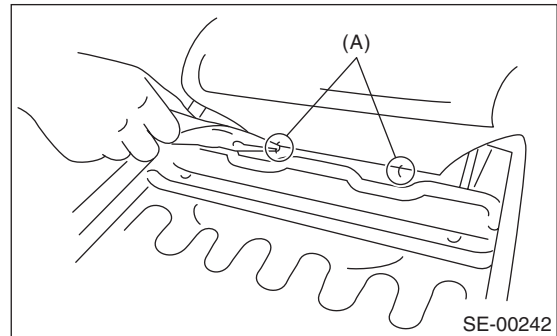

9) Remove the headrest bushing.

NOTE:

Push outside to remove it from the inside of seat.

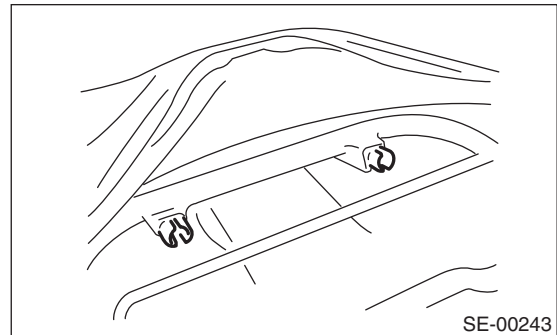

10) Pull out the backrest frame.

11) Remove the lower hog rings (A) on the front side of backrest.

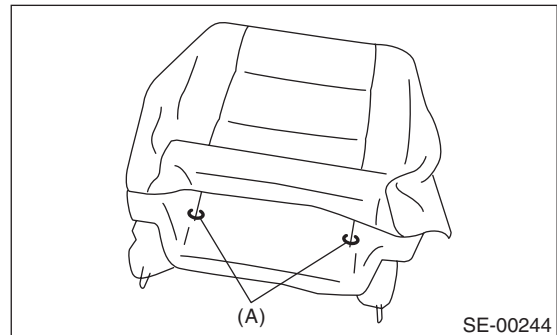

12) Remove the hog rings (A) on the front side of backrest, and then remove the backrest cover from backrest.

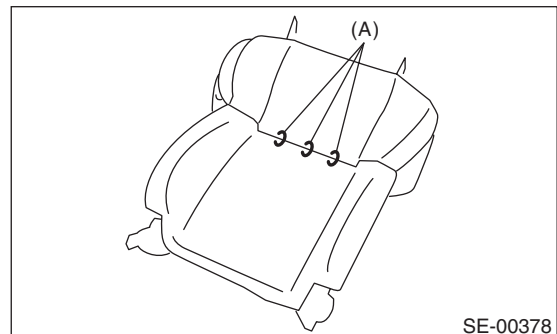

13) Remove the connecting wire (A), then loosen the bolt and nuts to remove slide rail.

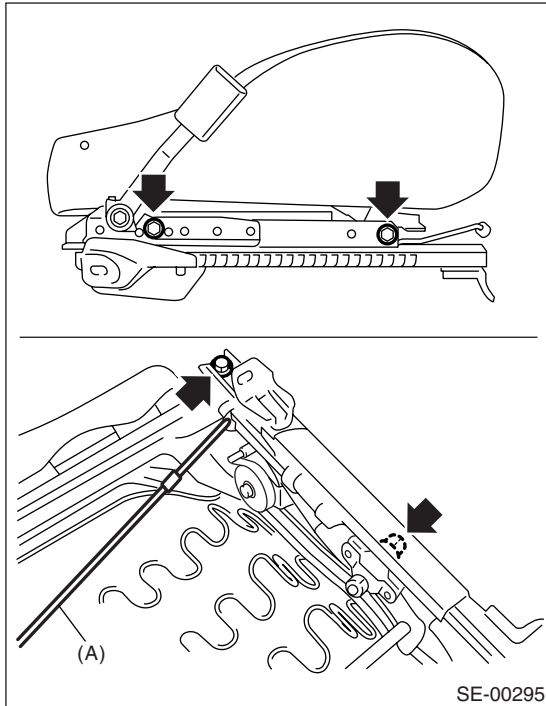

14) Remove the inner belt.

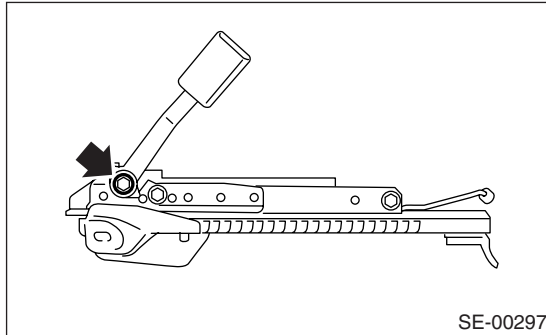

15) Remove the hooks (A), and then remove the seat cushion frame.

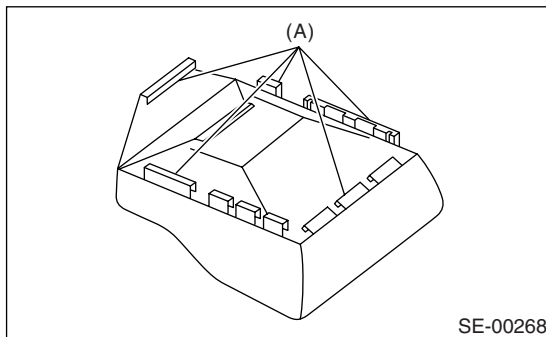

16) Remove the hog rings (A), and then remove the seat cushion cover from seat cushion pad.

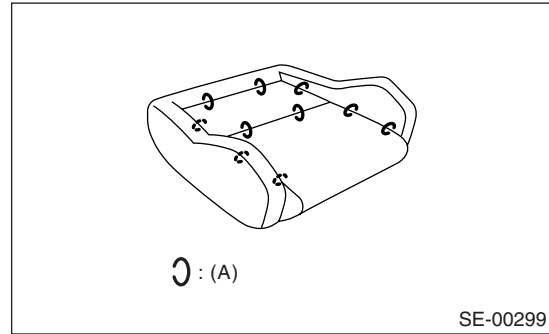

17) Open the fastener on the bottom of the headrest, then remove the headrest cover from the headrest.

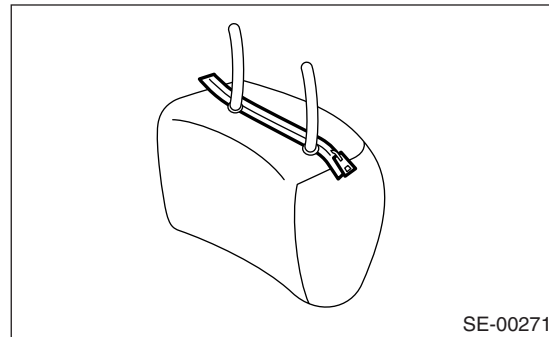

Power seat

- 1) Remove the seat from vehicle. <Ref. to SE-8, REMOVAL, Front Seat.>
- 2) Remove the seat switch knob.

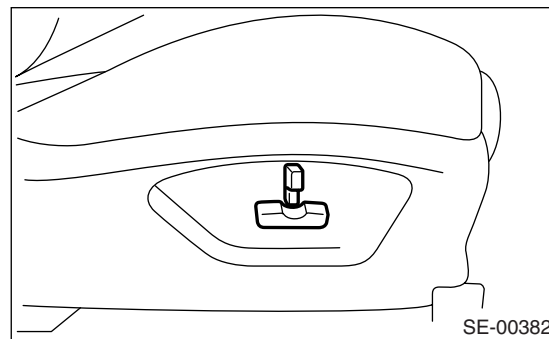

3) Disconnect the connector for reclining motor from the backside of seat cushion.

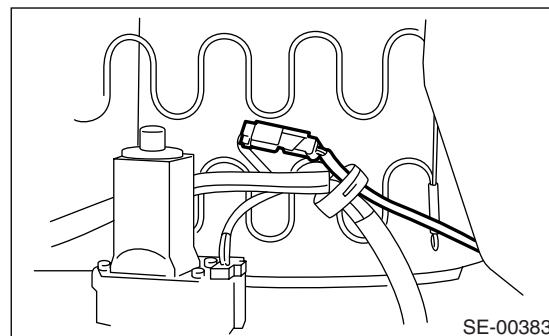

Front Seat

SEATS

4) Remove screws (A) and clips (B), and then disconnect the seat switch connector to remove the seat hinge outer cover.

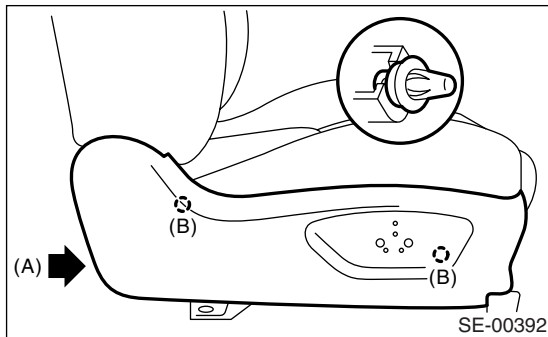

5) Remove screws (A) and clips (B), and then remove the seat hinge inner cover.

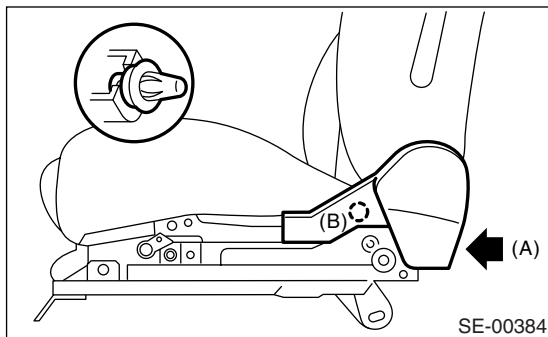

6) Remove the bolt, and then detach the inner belt.

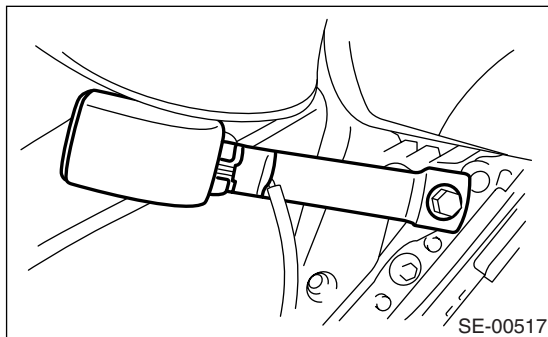

7) Remove the two bolts from the reclining hinge on each left and right side.

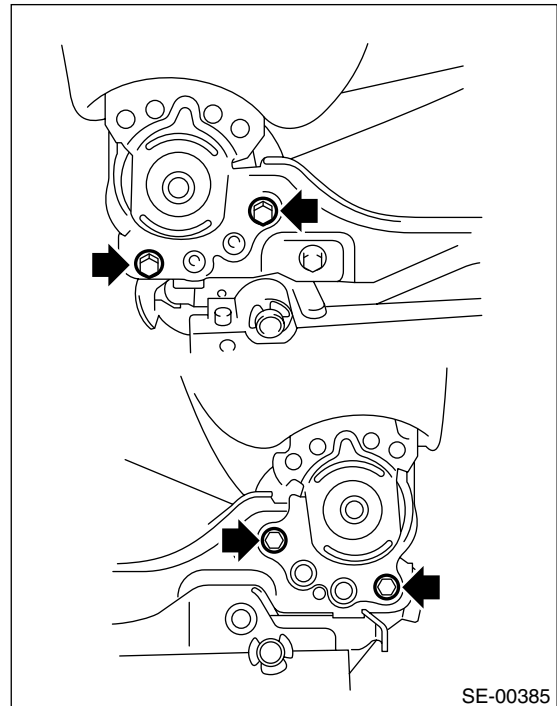

8) Remove the hook at bottom of seat backrest.

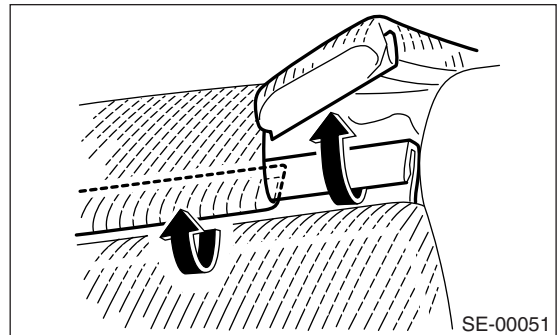

9) Open the fastener at the rear side of backrest.

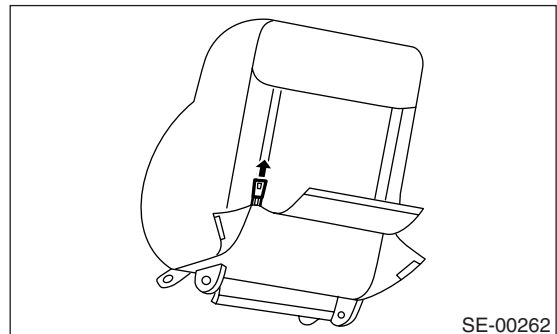

10) Remove the hog rings (A) on the front side of backrest from the backrest frame. (Seat with side airbag)

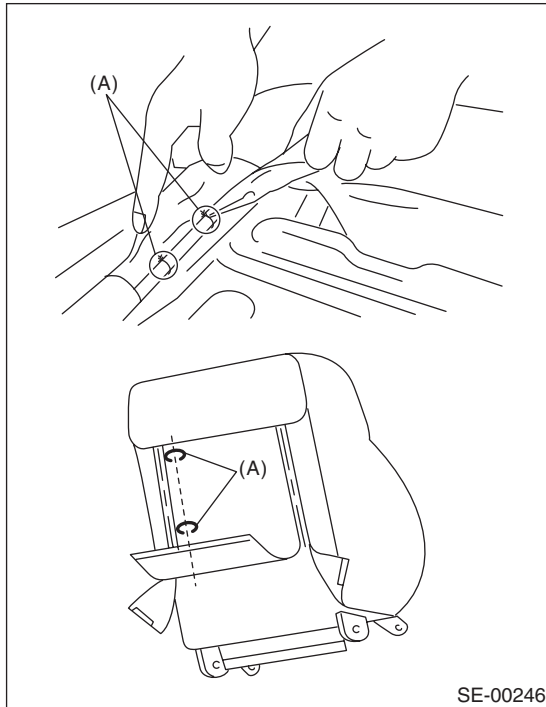

11) Remove the hog ring (A) which secures the backrest cover and backrest pad.

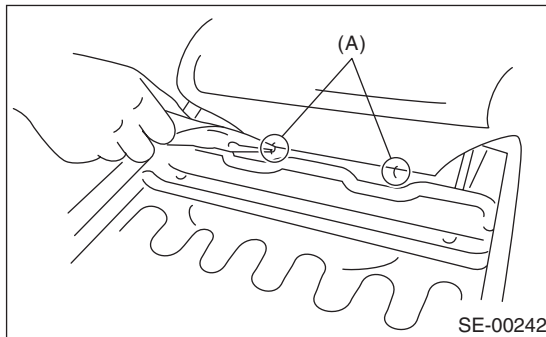

12) Remove the headrest lock bushing.

NOTE:

Push outside to remove it from the inside of seat.

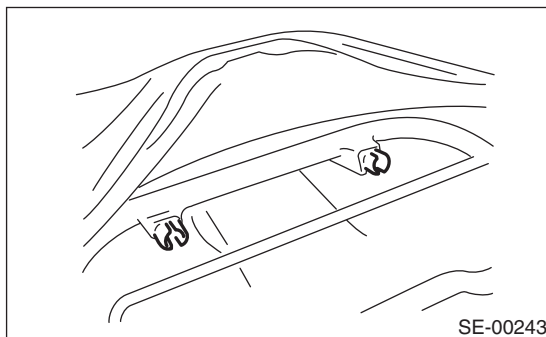

13) Pull out the backrest frame assembly.

14) Remove the two bolts on each left and right side, and then remove the reclining motor assembly.

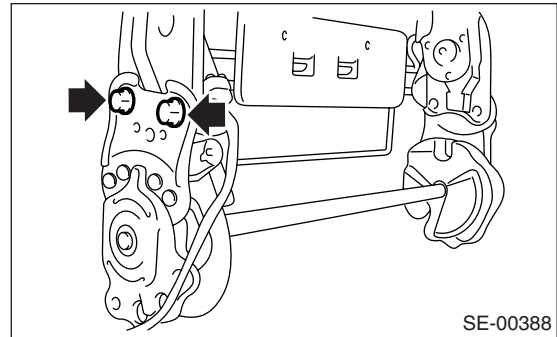

15) Remove the hog rings (A) on the surface side of backrest, and then remove the backrest cover from backrest.

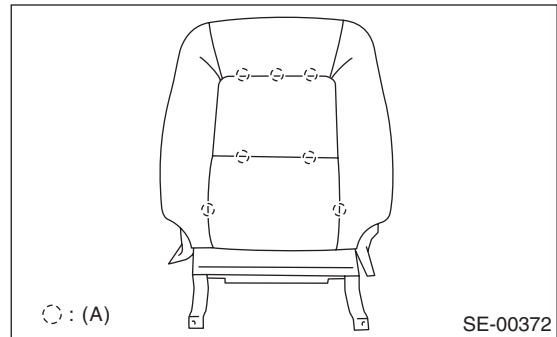

16) Remove the clip (A) and straps (B) on the back of seat cushion.

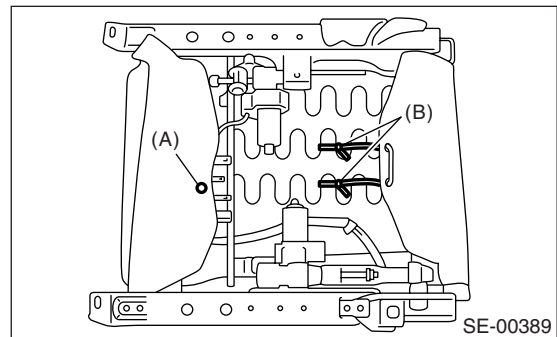

17) Remove the bolt (A) and hook (B) on left and right side, and then remove the seat cushion frame from seat rail assembly.

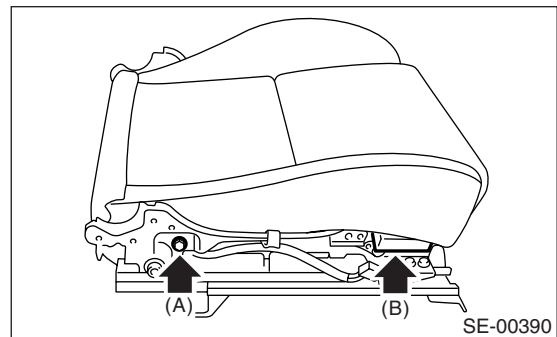

18) Remove the hooks (A), and then remove the seat cushion from seat cushion frame.

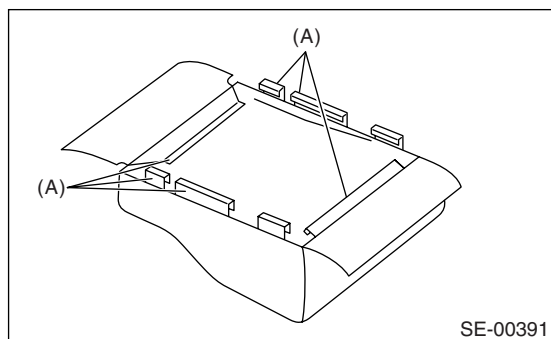

19) Remove the hog rings (A), and then remove the seat cushion cover from seat cushion pad.

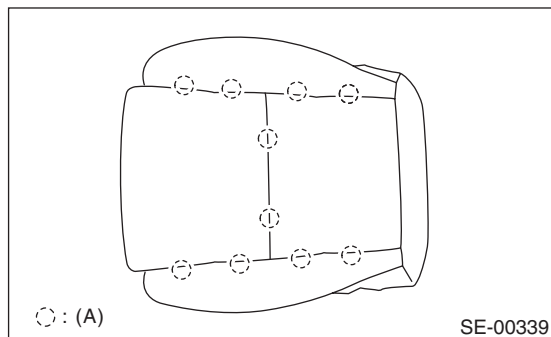

20) Remove the hook and hog ring on the bottom of the headrest, then remove the headrest cover from the headrest.

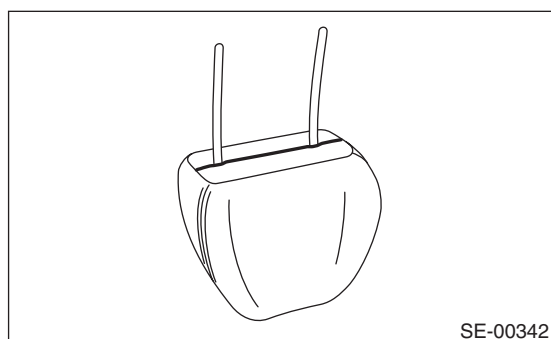

2. PASSENGER'S SEAT

CAUTION:

1. Vehicles before V.I.N. 733000

- On the passenger seat, never disassemble the seat cushion frame assembly and the slide rail, or remove the occupant detection control module or occupant detection sensors, or disconnect the harness connectors. These are all a part of the seat frame assembly.
- When removing the backrest, read the data of the occupant detection sensor with Subaru Select Monitor before removing the seat. <Ref. to OD(diag)-13, SENSOR DATA READ, OPERATION, Subaru Select Monitor.>

2. Vehicles after V.I.N. 733001

- If the seat cushion cover is removed or replaced, make sure to perform occupant detection system adjustment after installing the seat to the vehicle. <Ref. to OD(TYPE B)(diag)-18, SYSTEM CALIBRATION (REZEROING), OPERATION, Subaru Select Monitor.> Failure to do so may cause improper activation of the passenger's airbag.
- For the passenger seat, never remove the occupant detection control module and occupant detection sensor from the seat cushion frame. These are all occupant detection cushion assemblies.
- If the seat cushion cover is removed (including when replacing the heater), always replace the wires on the seat cushion cover with new wires.

- 1) Remove the seat from vehicle.
- 2) Remove the reclining lever cover.

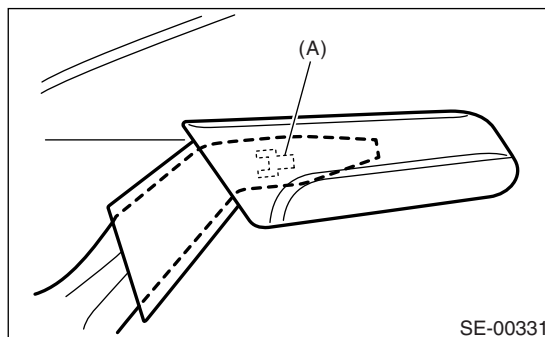

3) Remove screws (A), clips (B), and the claw (C), and then detach the seat side cover outside.

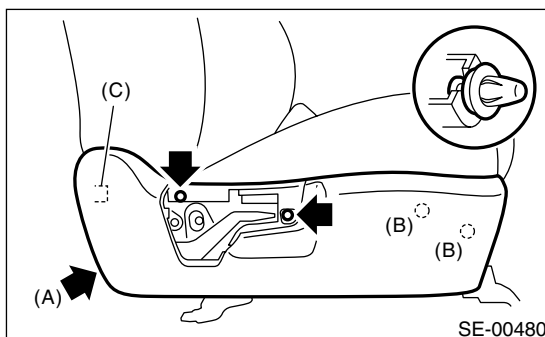

4) Remove screw (A) and detach claw (B), then remove the seat side cover inside.

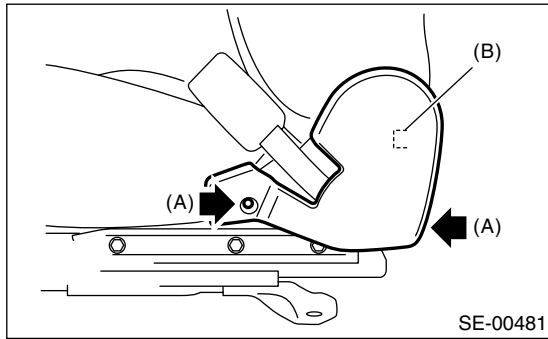

5) Remove the TORX® bolt, and then remove the inner seat belt assembly.

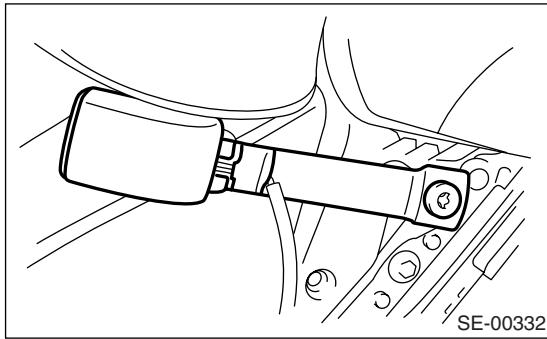

6) Remove two reclining hinge bolts from each side.

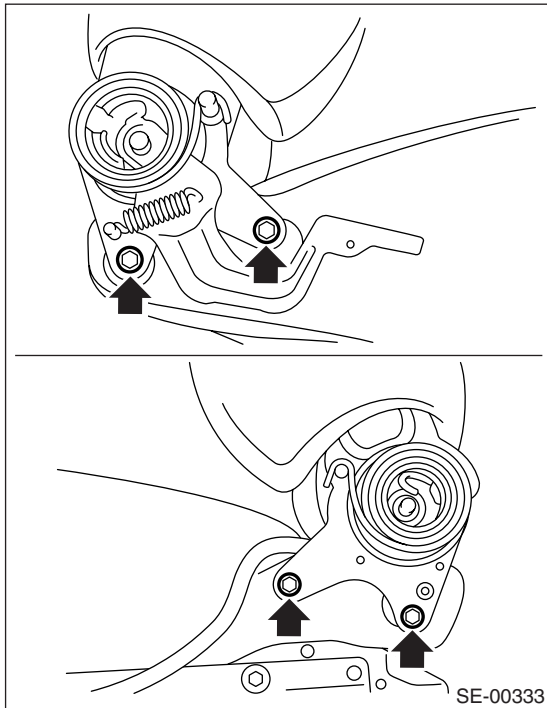

7) Remove the seat cushion pad & cover from the seat cushion frame assembly.

8) Remove the hog rings (A), and then remove the seat cushion cover from seat cushion pad.

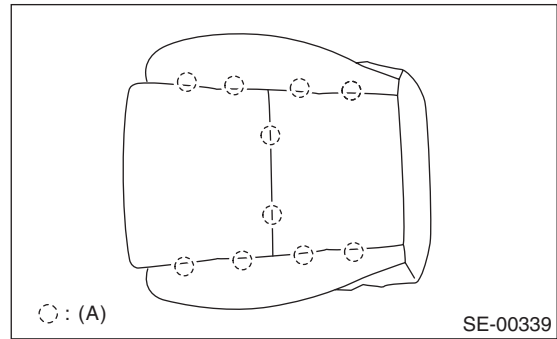

9) Refer to the driver's seat for disassembly procedures for the backrest and headrest.

10) Remove the inner belt.

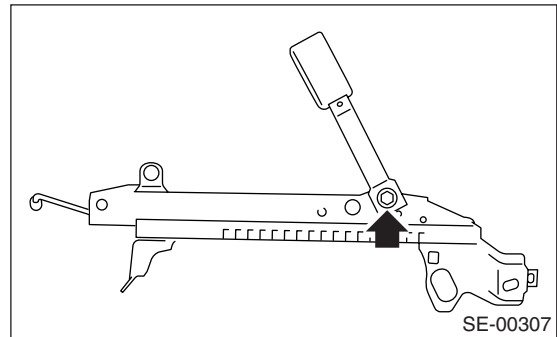

D: ASSEMBLY

CAUTION:

When the backrest cover is not installed securely, the side airbag module may not be deployed properly, therefore keep strictly to the following procedure.

- Be careful not to stain or damage the backrest cover during assembly.
- Do not reuse hog rings.
- Secure the hog ring using hog ring pliers.
- Install the hog rings to the specified points securely and make sure that no wrinkle or twisting on backrest cover.

1. DRIVER'S SIDE

Assemble in the reverse order of disassembly.

2. PASSENGER'S SIDE

CAUTION:

1. Vehicles before V.I.N. 733000

If the passenger seat is removed from the vehicle or even one attachment bolt is removed from the passenger seat, make sure to perform system adjustment of the occupant detection system after attaching the seat. <Ref. to OD(diag)-13, SYSTEM CALIBRATION, OPERATION, Subaru Select Monitor.>

Failure to do so may cause improper activation of the passenger's airbag.

2. Vehicles after V.I.N. 733001

If the seat cushion cover is removed or replaced, make sure to perform occupant detection system adjustment after installing the seat to the vehicle. <Ref. to OD(TYPE B)(diag)-18, SYSTEM CALIBRATION (REZEROING), OPERATION, Subaru Select Monitor.>

Failure to do so may cause improper activation of the passenger's airbag.

- 1) Assemble the seat cushion in the reverse order of disassembly.
- 2) Assemble the backrest in the reverse order of disassembly.
- 3) When installing the backrest assembly to the seat cushion assembly, fill the gap in the front side of slide rail LH and in the rear side of slide rail RH with cloth etc. in order to stabilize the seat cushion assembly.

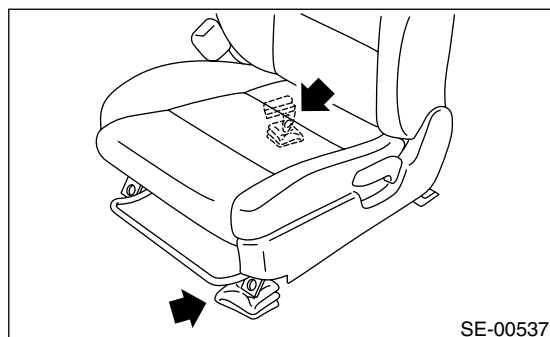

- 4) Temporarily tighten the reclining hinge bolts in the order of (1) through (4) to an extent that the seat backrest assembly is not held securely.

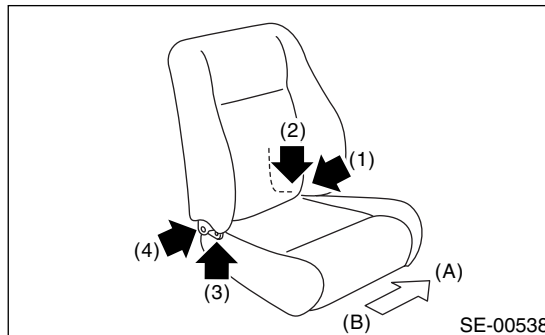

- (A) Vehicle inside
(B) Vehicle outside

- 5) Use the reclining lever to place the backrest in the most upright position, and check the first lock position of recliner.

- 6) Hold the seat cushion assembly securely, and tighten the reclining hinge bolts in the order described above until they reach the specified torque.

CAUTION:

Do not touch the backrest assembly when tightening the reclining hinge bolts.

- 7) Assemble each harness, inner belt assembly and each cover in the reverse order of removal.

Tightening torque:

Refer to "COMPONENT" of "General Description". <Ref. to SE-2, FRONT SEAT, COMPONENT, General Description.>

E: INSPECTION

Check that no tear or fray is on the backrest cover assembly.

NOTE:

When the door side of backrest cover assembly is torn or frayed, the side airbag may not be deployed properly. Replace it with new part in such a case.