

9. Headlight Assembly

A: REMOVAL

- 1) Disconnect the ground cable from battery.
- 2) Remove the air intake duct (when right side headlight is removed). <Ref. to IN(H4SO)-5, REMOVAL, Air Cleaner Case.>
- 3) Remove the front bumper. <Ref. to EI-21, REMOVAL, Front Bumper.>
- 4) Remove the four bolts and disconnect the connectors, and then detach the headlight assembly.

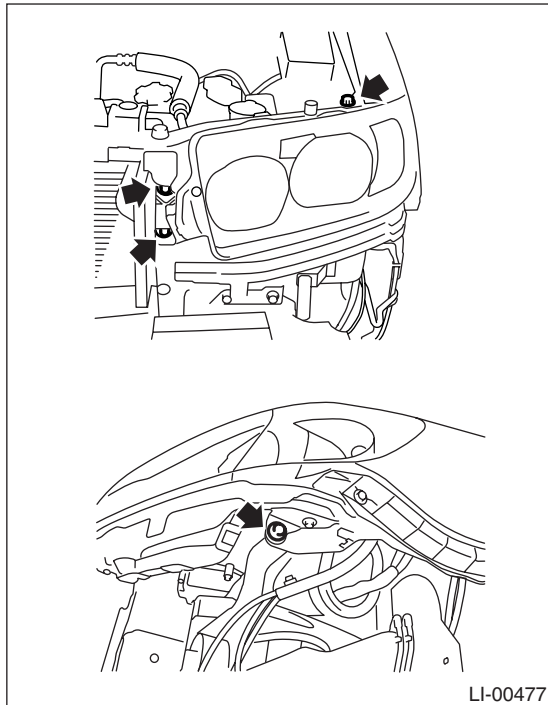

B: INSTALLATION

Install in the reverse order of removal.

C: DISASSEMBLY

1. LENS

CAUTION:

- Do not touch the bulb glass portion.
 - Do not touch inside the lens (extension portion) or reflector portion.
 - Replace the packing with a new one.
- 1) Remove the headlight assembly. <Ref. to LI-10, REMOVAL, Headlight Assembly.>
 - 2) Disconnect the headlight bulb connector.
 - 3) Remove the back cover and then remove the bulb.
 - 4) Use a drier to warm up the area around the seal through the bulb installation hole.

CAUTION:

Avoid heating one specific point of the seal portion and heating the headlight assembly to 120°C (248°F) or more.

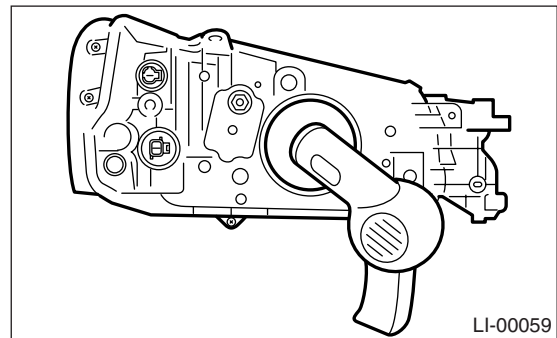

- 5) Remove the hook, and then take the lens off the headlight assembly.
- 6) Remove the packing (A) from seal groove.

CAUTION:

Completely remove the packing not to leave any residue behind.

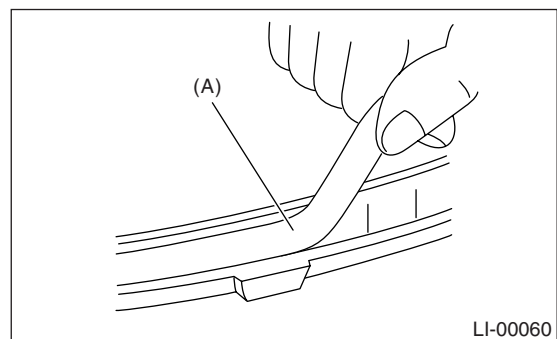

(A) Packing

2. HID HEADLIGHT BALLAST

CAUTION:

- Do not operate with wet hands.
 - As the lightening circuit on the HID headlights uses high voltage, be sure to confirm that the power supply is turned off before working on it.
 - Do not leave the headlight without a ballast for a long time. Dust, moisture, etc. entering the headlight may affect its performance.
- 1) Disconnect the ground cable from battery.
 - 2) Remove the headlight assembly. <Ref. to LI-10, REMOVAL, Headlight Assembly.>
 - 3) Remove the back cover.

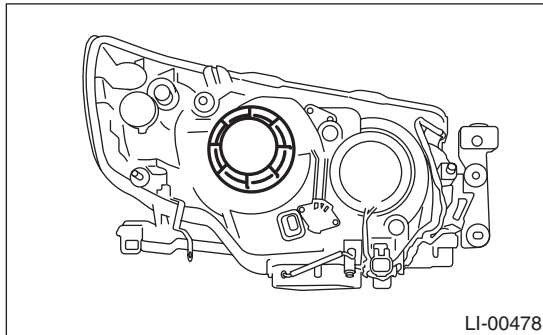

- 4) Disconnect the harness connector.

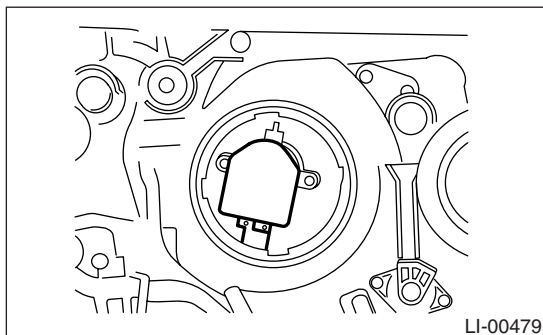

- 5) Loosen the screws to remove ballast.

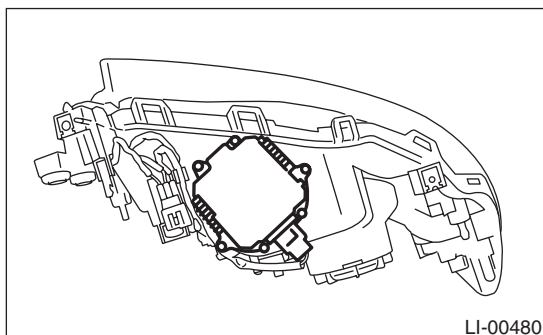

- 6) Disconnect the connector from the headlight ballast.

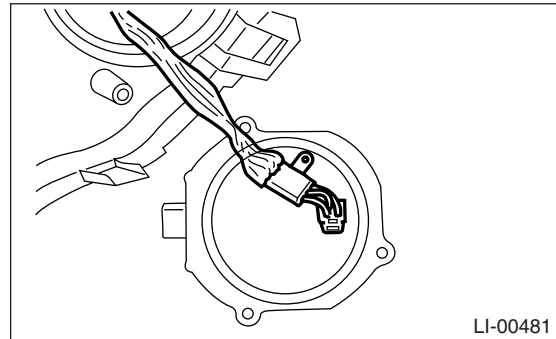

CAUTION:

Be careful because the notch is easily bent.

- 7) Turn the beam adjustment screw so that the beam is facing upward, then create space for the socket portion to pass through the inside of the lamp.

CAUTION:

The reflector should not interfere with the extension case.

- 8) Place the socket portion toward the front side of the reflector bracket.
- 9) Turn the beam adjustment screw so that the beam is facing downward, then create space for the socket portion to pass under the reflector bracket.

CAUTION:

The reflector should not interfere with the extension case.

- 10) Remove the socket from headlight from below the housing.

CAUTION:

The socket should not get sandwiched between the reflector and the lamp housing.

Headlight Assembly

LIGHTING SYSTEM

D: ASSEMBLY

1. LENS

- 1) Cut the tip of packing (A) at an angle of 45°.
- 2) With the cut end facing upward, insert packing (A) into the seal groove.

CAUTION:

- If the packing protrudes, slowly take it off the groove.
- Do not stretch the packing. If the packing is stretched, seal fails.

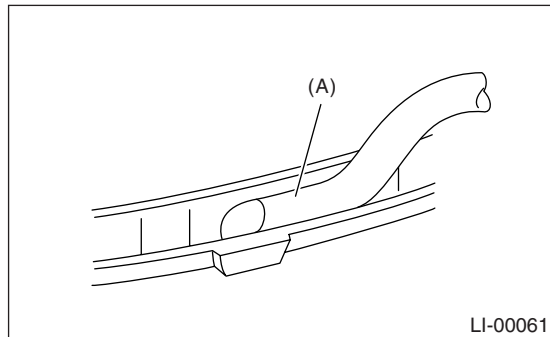

(A) Packing

- 3) After making a round of the seal, cut its tip at an angle of 45°, with its length 10 mm (0.39 in) longer than the circumference of seal so that the tip overlaps the other. Then, press it onto the seal, using a screwdriver.

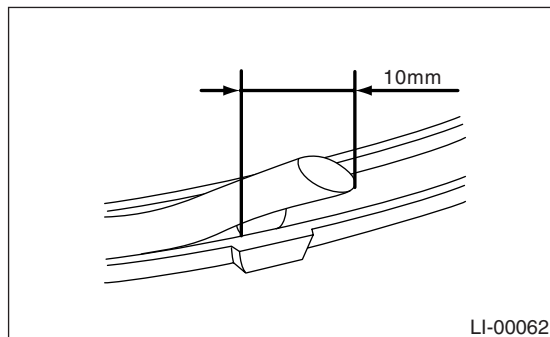

- 4) Match the positions of the lens and headlight assembly, and then insert the lens into the headlight assembly.
- 5) Engage the hooks.
- 6) Put the seal portion of headlight assembly into the water and check that water does not enter inside the headlight.

CAUTION:

Be sure that water does not enter inside the headlight through the bulb socket and ventilation hole.

E: ADJUSTMENT

1. HEADLIGHT AIMING

CAUTION:

Turn off the light before adjusting the headlight aiming. If it is necessary to inspect the aiming, do not turn on the lamp for more than two minutes.

NOTE:

Before checking the headlight beam level, be sure of the following:

- The area around the headlight does not have any scratch, damage or other type of deformation.
- Vehicle is parked on a level surface.
- The inflation pressure of tires is correct.
- Vehicle's fuel tank is full.
- Bounce the vehicle several times to normalize the suspension.
- Make certain that someone is seated in the driver's seat.

- 1) Cover the headlight that is not being adjusted with a cloth.
- 2) Turn the headlights on and then adjust the low beam while displaying the beam on the screen.

NOTE:

Adjust the vertical beam level (A) first, then horizontal beam level (B) using a screwdriver.

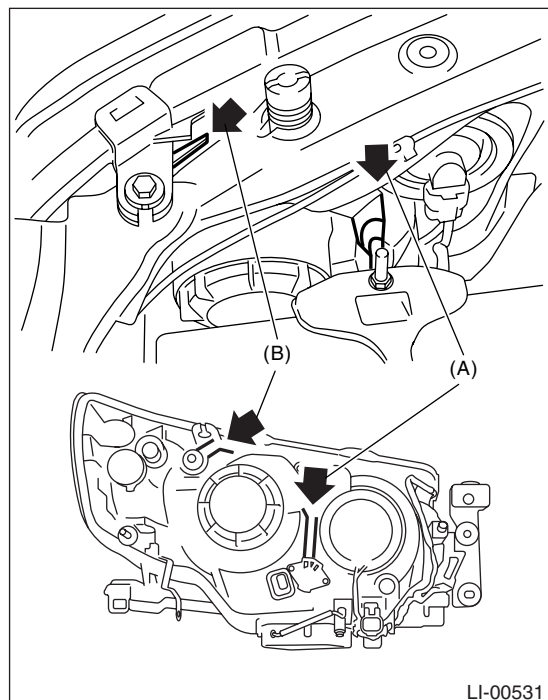

LIGHTING SYSTEM



(B) Bulb center marking

W mm (in)	H mm (in)	h mm (in) at 3 m (10 ft)
1,235 (48.6)	7601 (29.9)	21 (0.83)