

## 15.Rear Gate Glass

### A: REMOVAL

- 1) Remove the rear gate garnish. <Ref. to EB-20, REMOVAL, Rear Gate Garnish.>
- 2) Disconnect the electrical connectors from rear defogger terminal.
- 3) Remove the glass in the same procedure as for windshield glass. <Ref. to GW-25, REMOVAL, Windshield Glass.>

#### NOTE:

The locating pin is adhered to the corner portion on the vehicle's indoor side of the glass. Use the piano wire to cut each pin.

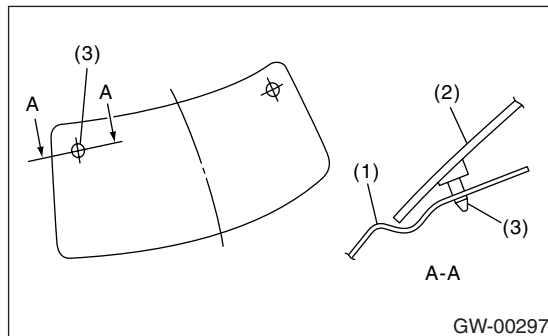

- (1) Body panel
- (2) Glass
- (3) Locating pin

### B: INSTALLATION

- 1) Install a new rubber strip (A) in position with the edge (B) of the rear gate glass.

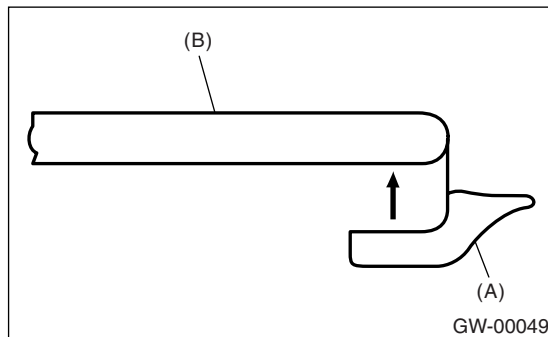

- 2) Install the glass in the same procedure as for windshield glass.

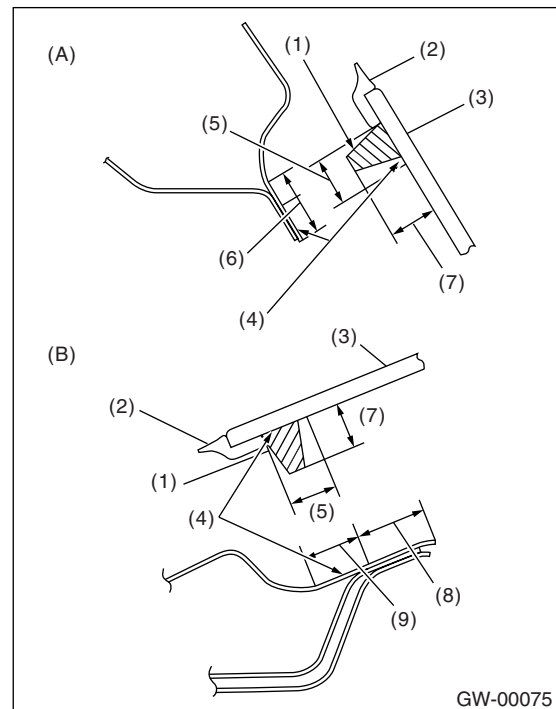

- (A) Upside
- (B) Left side and right side
- (1) Adhesive
- (2) Strip rubber
- (3) Glass
- (4) Primer
- (5) 12 mm (0.47 in)
- (6) 14 mm (0.55 in)
- (7) 10 — 13 mm (0.39 — 0.51 in)
- (8) 8 mm (0.31 in)
- (9) 12 mm (0.47 in)

- 3) About one hour after installation, inspect for leaks.
- 4) After completion of all work, allow the vehicle to stand for about 24 hours.

#### NOTE:

- When door is opened/closed after glass is bonded, always lower the door glass first, and then open/close it carefully.
  - Move the vehicle slowly.
  - For minimum drying time and vehicle standing time before driving after bonding, follow instructions or instruction manual from the adhesive manufacturer.
  - When a vehicle is returned to the user, tell him or her that the vehicle should not be subjected to heavy impact for at least three days.
- 5) Connect the rear defogger terminals.
  - 6) Install the rear gate garnish. <Ref. to EB-20, INSTALLATION, Rear Gate Garnish.>