

# General Description

## AIRBAG SYSTEM

### 1. General Description

#### A: COMPONENT

##### 1. SRS AIRBAG

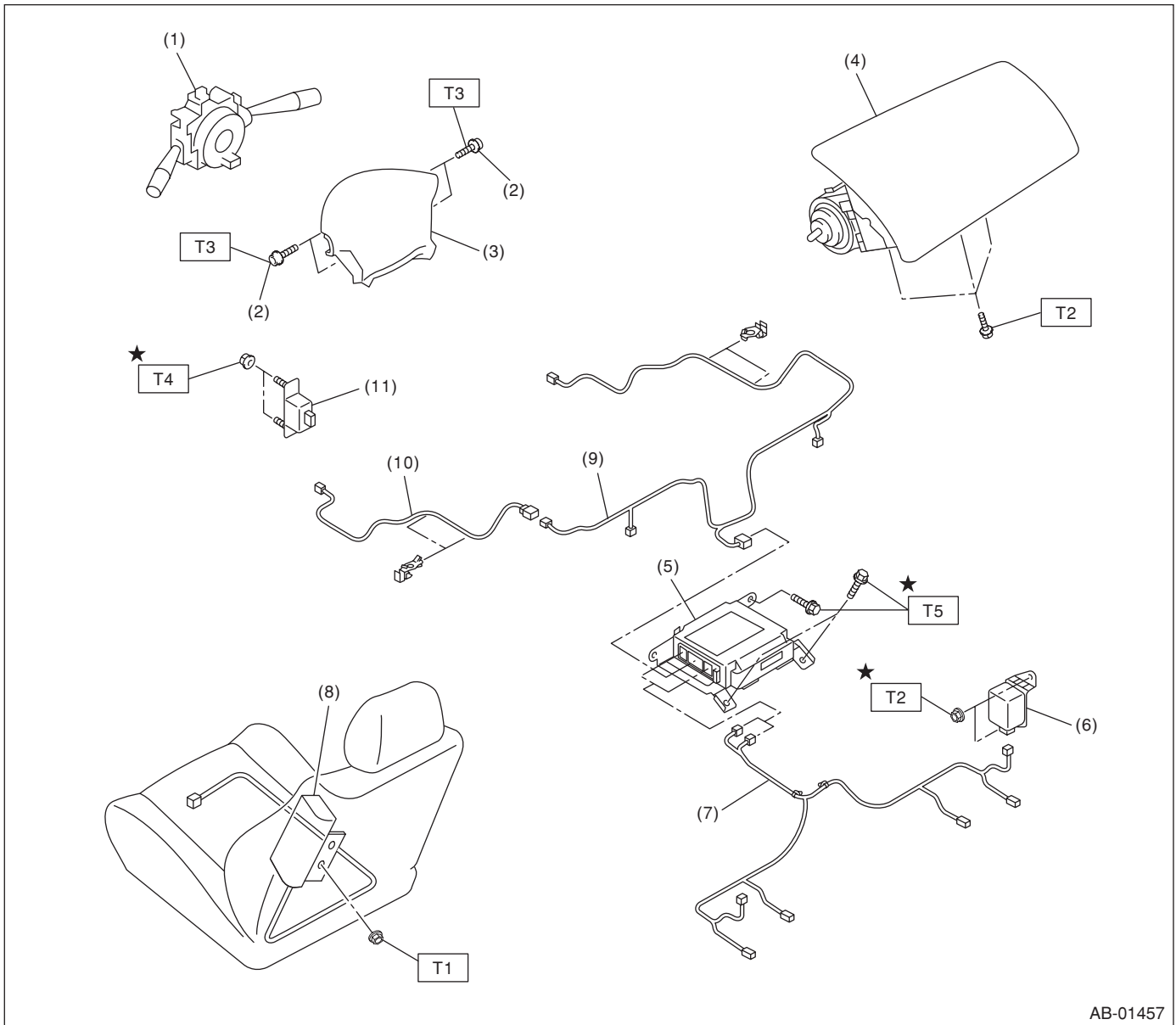

AB-01457

- |   |                           |
|---|---------------------------|
| (1) Combination switch ASSY with roll connector | (7) Wiring harness rear   |
| (2) TORX® bolt T30                              | (8) Side airbag module    |
| (3) Airbag module ASSY (Driver)                 | (9) Wiring harness center |
| (4) Airbag module ASSY (Passenger)              | (10) Wiring harness front |
| (5) Airbag control module                       | (11) Front sub sensor     |
| (6) Side airbag sensor                          | (12) Nut                  |
|   | (13) Bolt                 |

#### ***Tightening torque: N·m (kgf-m, ft-lb)***

***T1: 7.5 (0.8, 5.5)***

***T2: 7.4 (0.75, 5.4)***

***T3: 10 (1.0, 7.2)***

***T4: 20 (2.0, 14.5)***

***T5: 25 (2.5, 18.1)***

### 2. SEAT POSITION SENSOR

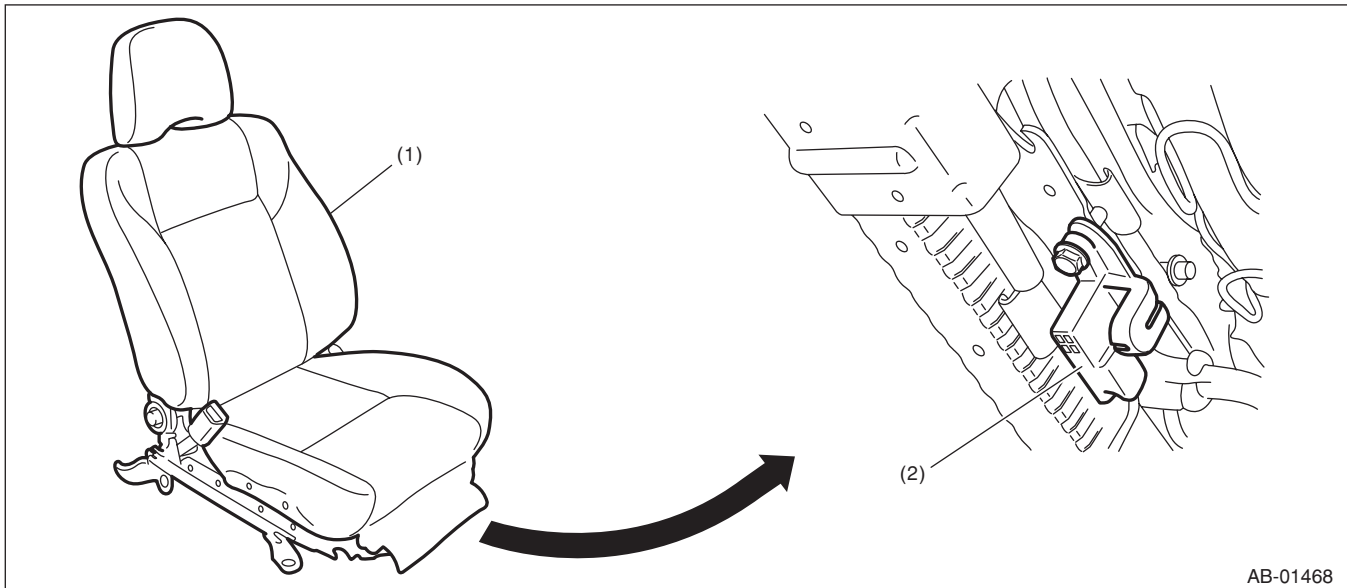

AB-01468

(1) Driver's seat

(2) Seat position sensor

#### B: CAUTION

- When servicing a vehicle, be sure to turn the ignition switch to OFF, disconnect the ground cable from battery, and wait for more than 20 seconds before starting work.
- The airbag system is fitted with a backup power source. After disconnecting the battery ground cable, the airbag may deploy if you do not wait for more than 20 seconds before starting airbag system servicing.

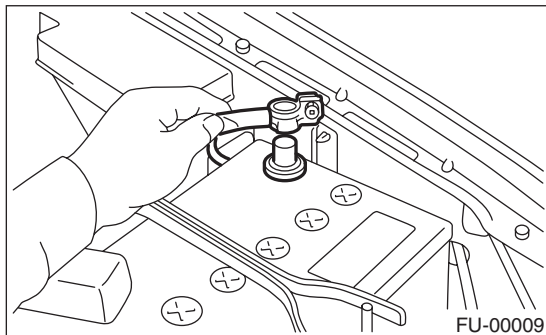

- If the airbag warning light illuminates, repair the vehicle immediately. Otherwise, the airbag or pretensioner may inflate incorrectly, or not inflate in collision.

- If sensors, airbag module, airbag control module, pretensioner or harness is deformed or damaged, replace with new parts.

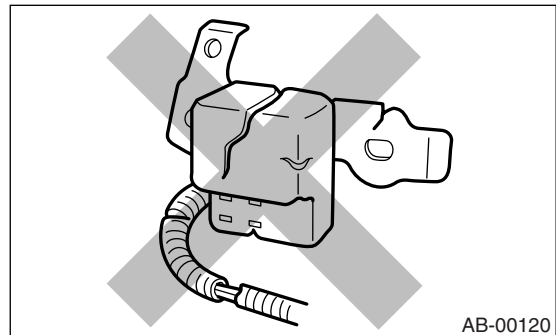

- When checking the airbag system, be sure to use a digital circuit tester. Use of an analog circuit tester may cause the airbag to activate erroneously due to a minimal current inside tester.

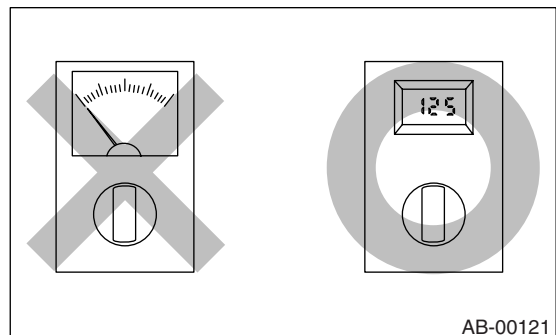

## General Description

### AIRBAG SYSTEM

- When checking, use a test harness (1). Damage to connector terminal cause malfunction. Do not directly apply the tester probe to connector terminal of airbag.

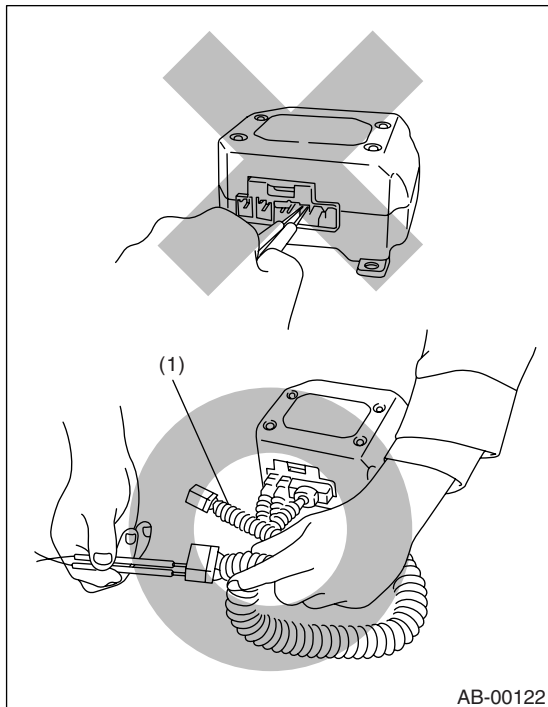

- Do not check continuity of the airbag modules for driver's side, passenger's side, or pretensioner.

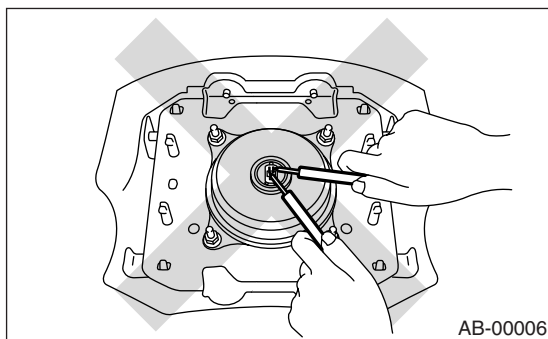

- Do not drop the airbag system parts, or keep them at high temperature over 93°C (199°F), or let water, oil or grease get on them; the internal parts may be damaged and reliability greatly lowered.

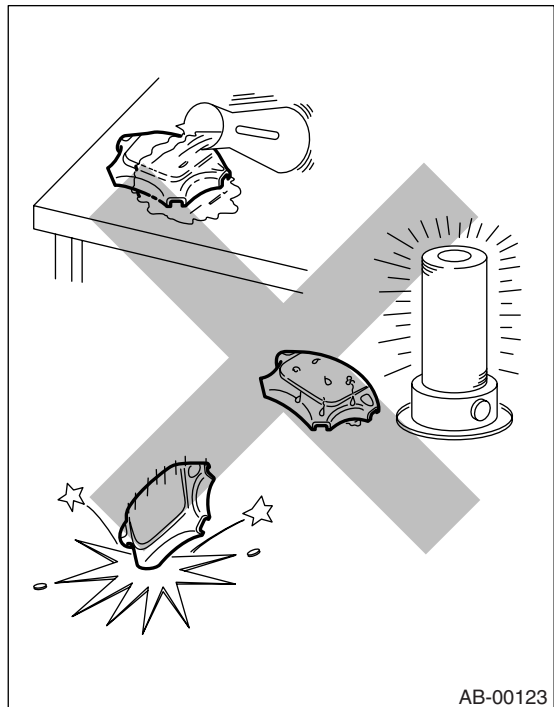

- If damage, open circuit or rust is found on airbag system wiring harness, do not use a soldering equipment to repair. Replace the faulty harness with a new genuine part.

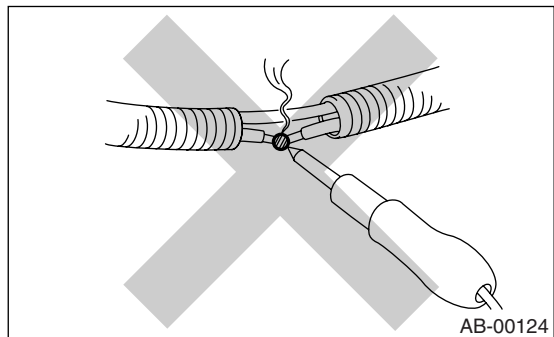

- Install the wiring harness securely with specified clips to avoid interference or becoming tangled with other parts.

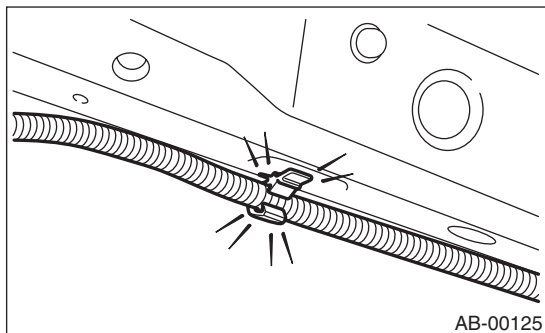

- Do not allow water or oil to come in contact with the connector terminals. Also, do not touch the connector terminals.

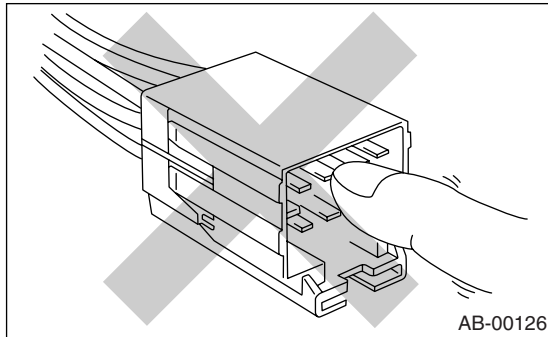

- After removal of each parts for airbag system, keep them with the pad facing upward on a dry, clean and flat surface without heat, light sources, moisture and dust.

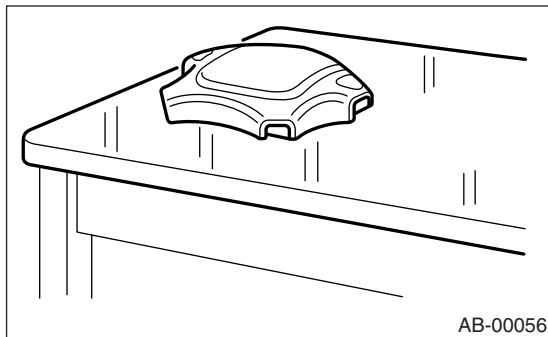

- When airbag control module, front sub sensor, side airbag sensor and curtain airbag sensor are removed, do not reuse the bolts and nuts of them. Always use new bolts and nuts for them.
- Either of the airbag modules for driver's, passenger's and side or the pretensioner must not be disassembled.

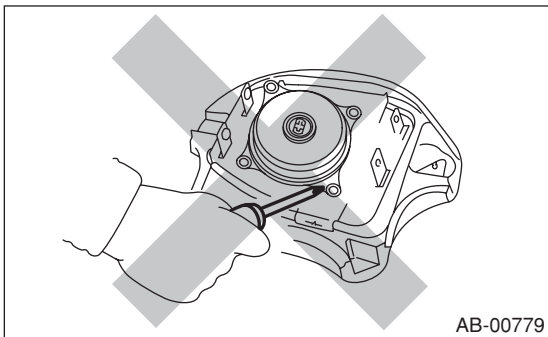

- The removed front seat with airbag module must be kept at least 200 mm (8 in) away from walls and other objects.

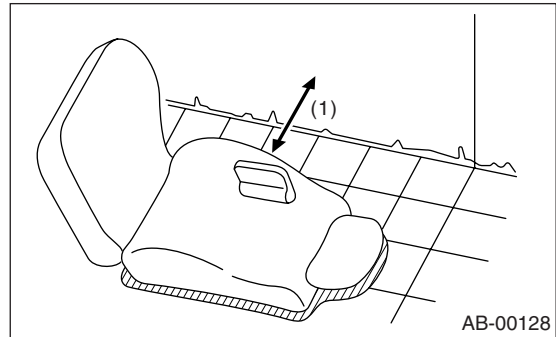

(1) 200 mm (8 in) or more

- Do not use the airbag or pretensioner parts from other vehicles. Always replace the defective parts with new parts.
- Never reuse a deployed airbag and pretensioner.
- When painting or performing sheet metal work on the front part of the vehicle, including the front wheel apron, front fender and front side frame, remove the front sub sensors and wiring harness of airbag system.
- When painting or performing sheet metal work on the side of the vehicle, including the side sill, center pillar and front and rear doors, remove the side airbag sensors and wiring harness of the airbag system.

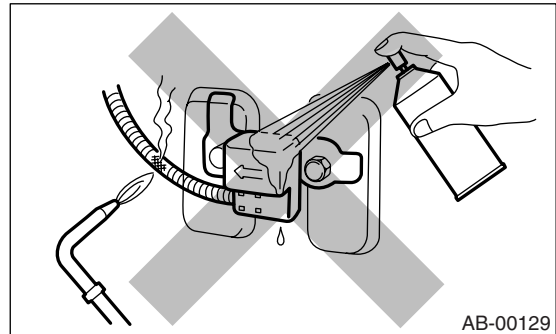

- When storing an airbag module that was removed, do not place with the pad side facing down. Do not place items on top of the airbag module. Do not stack airbag modules. If the airbag module pads are in contact with other objects, it may lead to a major accident when the airbag is deployed unexpectedly.

# General Description

## AIRBAG SYSTEM

(1)

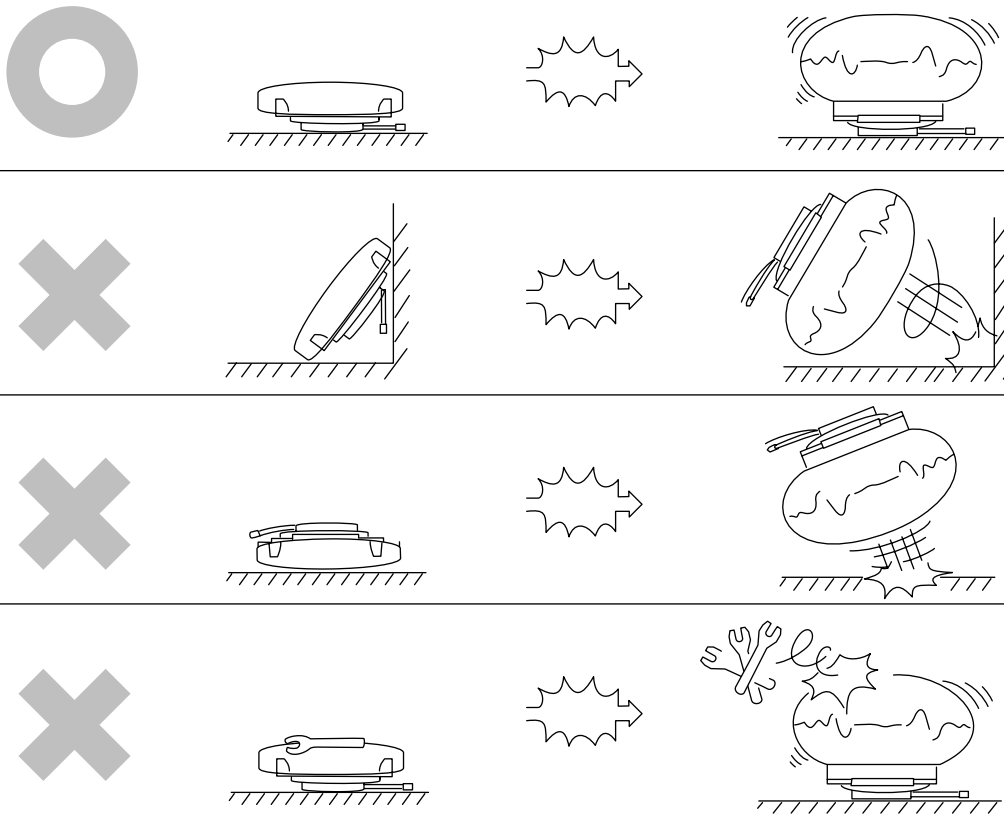

(2)

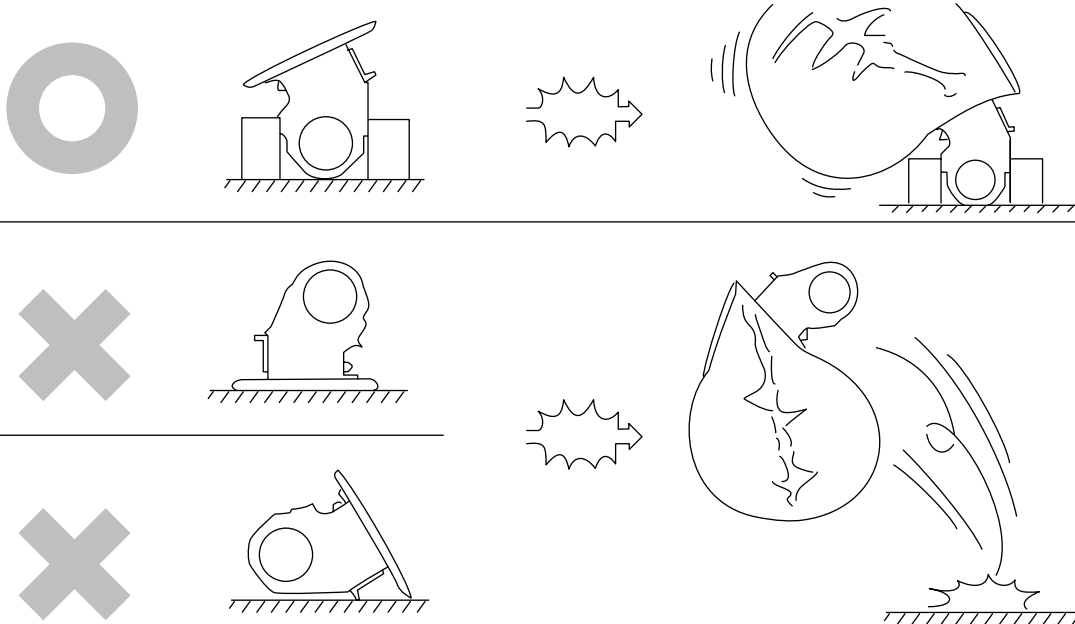

AB-00130

(1) Driver's airbag module

(2) Passenger's airbag module

## C: PREPARATION TOOL

### 1. GENERAL TOOL

TOOL NAME	REMARKS
TORX®T30	Used for removal/installation of drivers airbag module